

THIS DOCUMENT IS A TAX MAP. It is compiled for the purpose of taxation from available record evidence and has not been field verified. It is not a valid survey plat. The existence of data on this map does not imply any "official" status to such data. The Cabell County Assessor's Office assumes no liability that might result from the inappropriate use of this document.

RESTRICTIONS: All tax maps created under the provisions of the reappraisal legislation are the property Assessor of Cabell County, West Virginia and the reproduction, copying, modification, distribution, or sale of any copies thereof without the written permission of the Cabell County Assessor is prohibited by law.

Legend

Property Line	Original Lot Line	Lot Number (15)
Road Right of Way	Corporation Line	Parcel Number (99)
District Line	County Line	Water
		Railroad

R	1	Revised 6/1/15	9	17
e	2	Revised 6/1/16	10	18
v	3	Revised 12/30/2017	11	19
i	4		12	20
s	5		13	21
i	6		14	22
n	7		15	23
s	8		16	24

STATE OF WEST VIRGINIA
COUNTY OF CABELL
 Office of Assessor

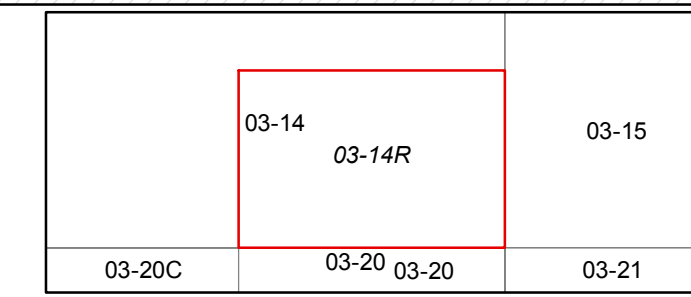

Grant District
 Map: 14R
 Date, Aerial Photography: 2015
 Date, Map: 1/30/2017
 Scale: 1" = 100'