

For Tax Purposes Only
 Prepared by
MICHAEL BAKER, JR., INC.
 Consulting Engineers
 Rochester, Pennsylvania

Legend	
Property line	Original lot line
Edge of pavement or roadway	Deed lot number
Corporation line	Parcel or index number
District line	Improvement
County line	Railroad

Revisions	
1	11-27-78 T.C. 9 SLS INC. - DDC 5/97 17
2	Revised 7-1-83 J.F. 10 SLS INC. 2/23/98 JWM 18
3	July 1986 TRL 11 ESI 2/20/03 REK 19
4	Rev. to 3-1-89 R.E.B. 12 3/21/05 S.B.H. 20
5	OGIS 1/26/93 DSH 13 6-22-09 H.S. 21
6	OGIS 12/12/93 SAJ 14 6-21-09 H.S. 22
7	OGIS 2-95 HD 15 5-4-13 H.S. 23
8	O.G.I.S. 4-1-96 J.E.B. 16 24

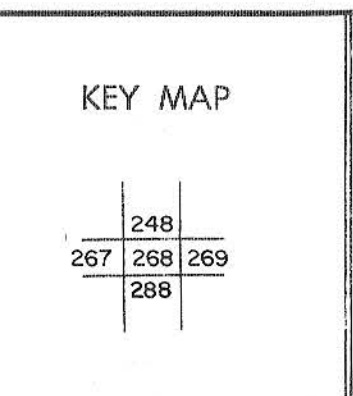

TUCKER COUNTY
 STATE OF WEST VIRGINIA
 Office of Assessor

DISTRICT **FAIRFAX DAVIS**
 SHEET NO: 268
 Date, Aerial Photography: November, 1961 Date, Map: Dec, 1962
 Photo No: Scale: 1" = 400'