

FOR TAX PURPOSES ONLY

Prepared By:

Ralph Layton
Grant County Assessor

Legend

Property Line	—	Original Lot Line	—
Road Right of Way	—	Lot Number	(15)
Corporation Line	—	Parcel Number	(99)
District Line	—	Water	—
County Line	—	Railroad	—

R	1	Revised 10/1/16	9		17
O	2	Revised 01/26/2022	10		18
V	3	Revised 01/16/2024	11		19
I	4		12		20
S	5		13		21
I	6		14		22
O	7		15		23
N	8		16		24

STATE OF WEST VIRGINIA
COUNTY OF GRANT
Office of Assessor

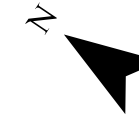
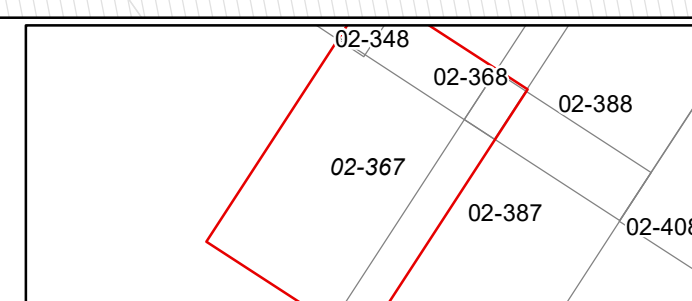

GRANT
Map: 367

Date, Aerial Photography: 2015
Date, Map: 1/26/2024
Scale: 1" = 400'