

Romney_Corp District

Romney District

District

WV LEGISLATIVE REGULATION
TITLE 189 SERIES 2009

Disclaimer: This map was compiled for purposes of taxation from available record evidence and has not been field verified. This map is not a valid survey plat and the data on this map does not imply any official status to such data. The State of West Virginia and county assessors' office assume no liability that might result from the use of this map.

Restrictions: All finished tax maps created under the provisions of legislation are the property of the county assessors who created them and the reproduction, copying, distribution, sale, or lease of such tax maps or copies thereof without the written permission of the respective county assessors is prohibited by law.



Legend

| | | | |
|------------------|-----------------|----------------------|------------------------|
| Corporation line | Railroad | School | Parcel or index number |
| District line | Lot line | Church | Parcel acreage |
| County line | Road Centerline | Deed lot number (25) | |
| State line | Streams | Trans Line | |
| Property Line | Cemetery | | |
| Right of Way | | | |

Revisions

| | | | |
|-------------------------|--------------------------|--------------------------|--------------------------|
| 1 AS OF JULY 1 1996 KWS | 6 AS OF JULY 1 2001 JVB | 11 AS OF JULY 1 2007 JVB | 16 AS OF JAN 1 2014 ASC |
| 2 AS OF JULY 1 1997 KWS | 7 AS OF JULY 1 2002 JVB | 12 AS OF JULY 1 2008 RIR | 17 AS OF JAN 1 2015 ASC |
| 3 AS OF JULY 1 1998 JVB | 8 AS OF JULY 1 2003 JVB | 13 AS OF JULY 1 2011 ASC | 18 AS OF JAN 31 2019 AGD |
| 4 AS OF JULY 1 1999 JVB | 9 AS OF JULY 1 2004 JVB | 14 AS OF MAR 29 2012 ASC | 19 AS OF JAN 31 2020 AGD |
| 5 AS OF JULY 1 2000 JVB | 10 AS OF JULY 1 2005 JVB | 15 AS OF JAN 1 2013 ASC | 20 AS OF JAN 31 2022 AGD |
| | | | 21 AS OF JAN 18 2024 AGD |

STATE OF WEST VIRGINIA
COUNTY OF HAMPSHIRE
Office of Assessor

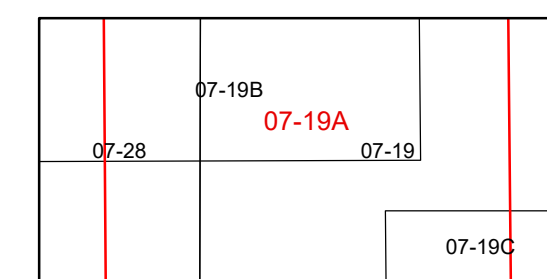

Romney
Map: 19A
Created: 1/19/2024
Scale: 1 in = 100 ft