

THIS DOCUMENT IS A TAX MAP: It was compiled for purposes of taxation from available record evidence and has not been field verified. This map is not a valid survey plat. The existence of data on this document does not imply any "official" status to such data. The W.V. State Tax Dept. and the Hancock County Assessor's Office assume no liability that might result from use of this document.

| Legend            |                          |
|-------------------|--------------------------|
| Property Line     | Original Lot Line        |
| Road Right of Way | Lot Number (15)          |
| Corporation Line  | Parcel Number (99)       |
| District Line     | Water                    |
| County Line       | Railroad                 |
| Road              | Home/Commercial Building |

|   |    |                    |    |    |
|---|----|--------------------|----|----|
| R | 11 | Revised 07/20/2020 | 9  | 17 |
| O | 2  | Revised 2/9/2021   | 10 | 18 |
| V | 2  | Revised 1/25/2022  | 11 | 19 |
| I | 2  | Revised 1/03/2023  | 12 | 20 |
| S | 5  | Revised 1/18/2024  | 13 | 21 |
| I | 6  |                    | 14 | 22 |
| O | 7  |                    | 15 | 23 |
| N | 8  |                    | 16 | 24 |

**STATE OF WEST VIRGINIA**  
**HANCOCK COUNTY ASSESSOR**  
 New Cumberland, West Virginia  
 Joseph M. Alongi, Assessor

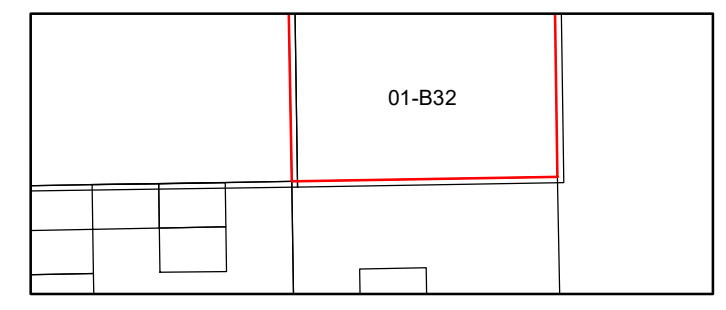

**BUTLER**  
 Map: B32  
 Date, Aerial Photography: 2003  
 Date, Map: 1/18/2024  
 Scale: 1" = 400'