

FOR TAX PURPOSES ONLY

Prepared By:  
Eric Buzzard  
Marshall County Assessor

Legend	
Property Line	Original Lot Line
Road Right of Way	Lot Number (15)
Corporation Line	Parcel Number (99)
District Line	Water
County Line	Railroad

R	1	Revised 3/1/15	9		17
O	2	Revised 1/27/2020	10		18
V	3	Revised 1/27/2021	11		19
I	4	Revised 1/31/2022	12		20
S	5	Revised 1/22/2024	13		21
I	6		14		22
O	7		15		23
N	8		16		24

STATE OF WEST VIRGINIA  
COUNTY OF MARSHALL  
Office of Assessor

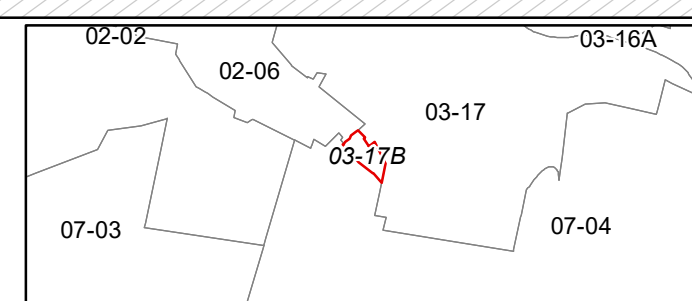

CAMERON DISTRICT  
Map: 17B

Date, Aerial Photography: 2013  
Date, Map: 1/22/2024  
Scale: 1" = 100'