

102

NORFOLK & WESTERN RR

NORFOLK & WESTERN RR

ELKHORN MTN HWY

LOOP BRANCH

ELKHORN MTN HWY

LOOP BRANCH RD

15

18  
1.83 Ac.

19  
(4)

20  
(3)

21  
(2)

22  
(1)

59  
.33 Ac.

62  
.35 Ac.

58  
.3 Ac.

60  
.45 Ac.

63  
.7 Ac.

61  
.37 Ac.

64  
.8 Ac.

23  
(10)

24  
(9)

25  
(8)

26  
(7)

27  
(6)

28  
(5)

29  
(4)

30  
(3)

31  
(2)

32  
(1)

33  
(5)

34  
(4)

35  
(3)

36  
(2)

37  
(1)

67  
.3 Ac.

66  
.45 Ac.

46  
.32 Ac.

47  
(1)

48  
(2)

49  
(3)

50  
(4)

51  
(5)

52  
(6)

53  
(7)

54  
(8)

55  
(9)

56  
(10)

57  
(11)

FOR TAX PURPOSES ONLY

Prepared By:  
Avery Ray Bailey  
McDowell County Assessor

Legend	
Property Line	Original Lot Line
Road Right of Way	Lot Number (15)
Corporation Line	Parcel Number (99)
District Line	Water
County Line	Railroad

R	1	Revised 2/11/2021	9		17
v	2	Revised 1/27/2023	10		18
i	3	Revised 9/18/2023	11		19
s	4		12		20
o	5		13		21
n	6		14		22
s	7		15		23
	8		16		24

STATE OF WEST VIRGINIA  
COUNTY OF McDOWELL  
Office of Assessor

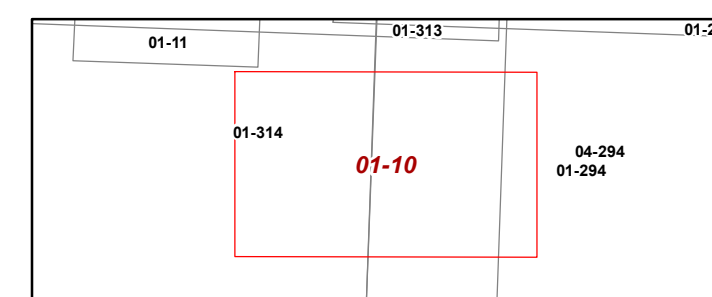

ADKIN DISTRICT  
Map: 10  
Date, Aerial Photography: 2019  
Date, Map: 3/15/2024  
Scale: 1 inch = 100 feet