

FOR TAX PURPOSES ONLY

Prepared By:

Ramona Mahon
Mingo County Assessor

Legend

Property Line	—	Original Lot Line	—
Road Right of Way	—	Lot Number (15)	—
Corporation Line	—	Parcel Number (99)	—
District Line	—	Water	—
County Line	—	Railroad	—

R	1	Revised 1/1/18	9		17
O	2	Revised 1/31/2022	11		18
V	3	Revised 3/24/2024	12		19
I	4		13		20
S	5		14		21
I	6		15		22
N	7		16		23
S	8				24

STATE OF WEST VIRGINIA
COUNTY OF MINGO
Office of Assessor

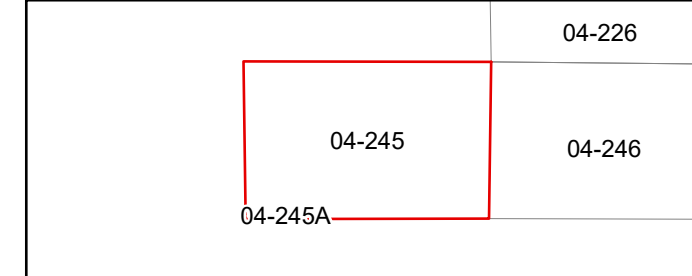

HARVEY
Map: 245

Date, Aerial Photography: 2003
Date, Map: 3/26/2024
Scale: 1" = 400'