

FOR TAX PURPOSES ONLY

LANDMARK geospatial
A Division of Landmark Forestry LLC

Legend

	District Boundary		Deed lot Number (15)
	Previous Deed		Parcel or Index Number (9)
	Property		Unknown
	Road Easement		Improvement
	Railroad Right of Way		Cemetery
	Road Right of Way		Church
	River		Educational

Restriction

REPRODUCTION OF TAX MAPS PROHIBITED - It is unlawful to copy, photocopy, scan, photograph, or otherwise reproduce this tax map. Pursuant to the provisions of W. Va. CSR § 189-5-5 (2013) no person may reproduce, copy, distribute or sell copies of tax maps prepared by the counties without having first obtained the written permission of the Nicholas County Assessor. In addition to other penalties and civil remedies, any person who, without the written permission of the Nicholas County Assessor, reproduces, copies, distributes, or sells or who allows the reproduction, copying, distribution or sale of tax maps prepared by the Nicholas County Assessor, shall be refused permission by the Nicholas County Assessor or Assessor's agent to purchase tax maps in the future.

1	10	19	28
2	11	20	29
3	12	21	30
4	13	22	31
5	14	23	32
6	15	24	33
7	16	25	34
8	17	26	35
9	18	27	36

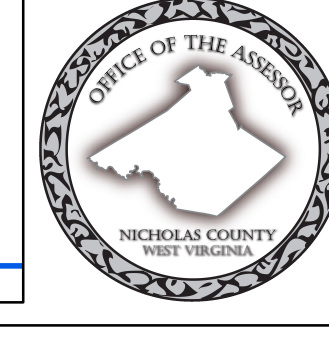
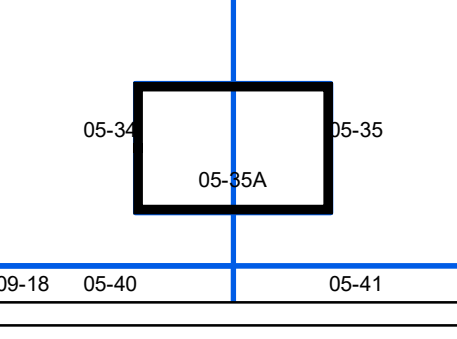

NICHOLAS COUNTY KENTUCKY

Assessor's Office
SUMMERSVILLE, WV

District 05 Map No. 35A
Date of Publication: 11/1/2023
Scale: 1"=100'