



FOR TAX PURPOSES ONLY
 Prepared By:
Tiffany Hoffman
 Ohio County Assessor

Legend	
Property Line	Original Lot Line
Road Right of Way	Lot Number (15)
Corporation Line	Parcel Number (99)
District Line	Water
County Line	Railroad

R	1	Revised 9/3/2019	9		17
O	2	Revised 01/28/2020	10		18
V	3	Revised 01/28/2021	11		19
I	4	Revised 01/28/2022	12		20
S	5	Revised 01/28/2023	13		21
I	6	Revised 01/26/2024	14		22
O	7		15		23
N			16		24
S					

STATE OF WEST VIRGINIA
COUNTY OF OHIO
 Office of Assessor

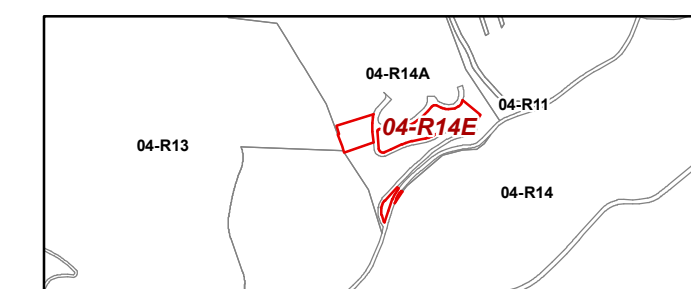

Richland
 Map: R14E

Date, Aerial Photography: 2015
 Date, Map: 1/26/2024
 Scale: 1" = 100'