



PREPARED BY
 THE MAPPING / GIS STAFF OF:
SHERRY L. HAYES
PUTNAM COUNTY ASSESSOR
 3389 WINFIELD ROAD
 WINFIELD, WV 25213
 PHONE: (304) 586-0206
 FAX: (304) 586-0226
 Date: 1/14/2025

FOR TAX PURPOSES ONLY
 ALL TAX MAPS CREATED UNDER THE PROVISIONS OF
 REAPPRAISAL LEGISLATION ARE THE PROPERTY OF
 PUTNAM COUNTY WEST VIRGINIA AND THE
 REPRODUCTION, COPYING, DISTRIBUTION OR SALE
 OF SUCH TAX MAPS OR ANY COPIES THEREOF
 WITHOUT THE WRITTEN PERMISSION OF THE PUTNAM
 COUNTY ASSESSOR IS PROHIBITED BY LAW.

LEGEND	
	Road ROW
	Parcel Boundary
	Road-Rail ROW
	District
	Rivers/Lakes
	Parcel Hook
	Lot line/Easement
	Parcel-Road ROW
	MapBooks
	Utility Easement
	Parcel Number
	Routing Number
	Deed Lot Number

Revisions	
1.	1/2/2024 UPDATE SUPPLIED TO STATE (BAS)
2.	1/06/2021 UPDATE SUPPLIED TO STATE (JSH)
3.	1/03/2019 UPDATE SUPPLIED TO STATE (JSH)
4.	1/1/2019 UPDATE SUPPLIED TO STATE (JSH)
5.	1/14/2015 UPDATE SUPPLIED TO STATE (BAS)
6.	1/7/2016 UPDATE SUPPLIED TO STATE (BAS)
7.	1/7/2017 UPDATE SUPPLIED TO STATE (BAS)

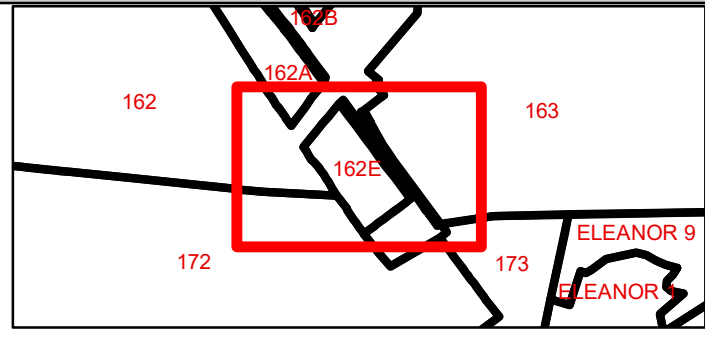

PUTNAM COUNTY
 STATE OF WEST VIRGINIA
 OFFICE OF ASSESSOR

Sheet No.: **162E**
 District: **BUFFALO**
 Date, Aerial Photography: **2010**
 Scale: **1" = 100'**