

FAYETTE COUNTY
RALEIGH COUNTY

TOWN DISTRICT

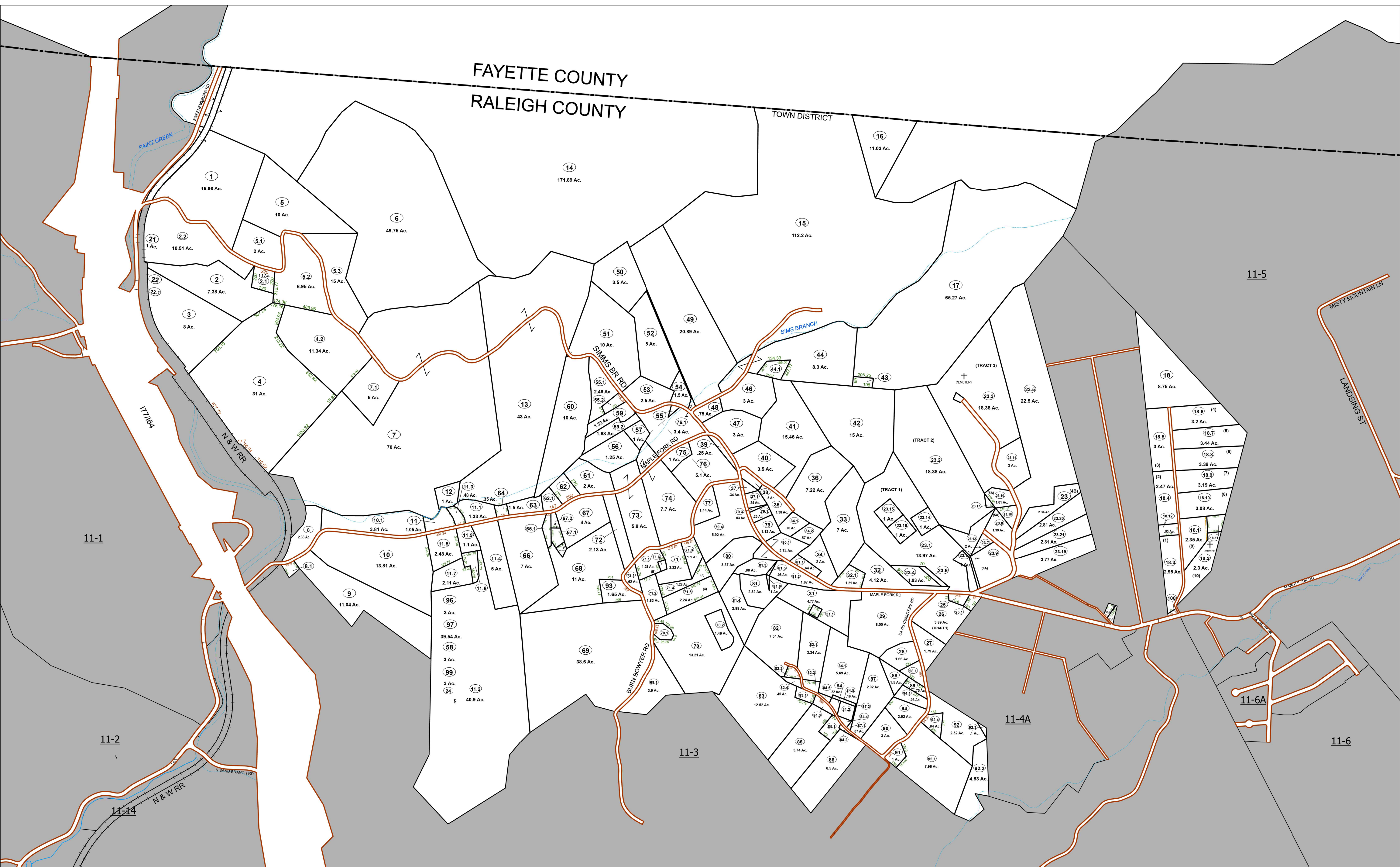

FOR TAX PURPOSES ONLY
Prepared By:
Raleigh County Assessor's Office
Beckley, WV

1	10/07/96 CLG	9	05/11/15 JLW	17
2	04/02/01 CLG	10	05/11/15 JLW	18
3	10/26/05 CLG	11	08/26/2021 AGD	19
4	03/27/06 CLG	12		20
5	01/18/07 CLG	13		21
6	10/30/07 ADL	14		22
7	07/05/08 ADL	15		23
8	09/24/10 TPB	16		24

RESTRICTION
ALL TAX MAPS CREATED UNDER THE PROVISIONS OF REAPPRAISAL LEGISLATION ARE THE PROPERTY OF RALEIGH COUNTY, WEST VIRGINIA. THE REPRODUCTION, COPYING, DISTRIBUTION, OR SALE OF SUCH TAX MAPS OR ANY COPIES THEREOF WITHOUT THE WRITTEN PERMISSION OF THE RALEIGH COUNTY ASSESSOR IS PROHIBITED BY LAW.

Legend

Property Line	—	Original Lot Line	—
Road Right of Way	—	Lot Number	(15)
Corporation Line	—	Parcel Number	99
District Line	—	Water	—
County Line	—	Railroad	—

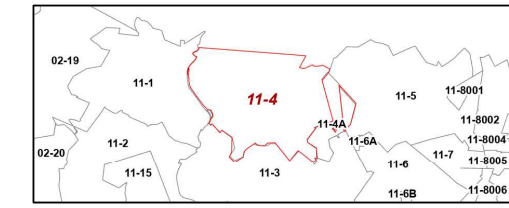

**COUNTY OF RALEIGH
OFFICE OF ASSESSOR
BECKLEY, WEST VIRGINIA**

TOWN DISTRICT
Map: 4
Date, Aerial Photography: 2018
Date, Map: 1/4/2024