

**FOR TAX PURPOSES ONLY**

Prepared by  
**RITCHIE COUNTY**  
**ASSESSOR'S OFFICE**  
**MERIDETH KUHN, ASSESSOR**  
**HARRISVILLE, W.Va.**

**LEGEND**

Property line	—————
Edge of pavement or roadway	-----
Corporation line	.....
District line	- - - - -
County line	-----
Waterways	~~~~~

Original lot line	-----
Deed lot number	(15)
Parcel or index number	99
Improvement	o
Railroad	+++++

**REVISIONS**

1.	4/5/04 S&H
2.	5/17/2011 RTI
3.	11/20/10 S&H
4.	2/12/2014 PJHH
5.	
6.	
7.	
8.	
9.	
10.	

**RESTRICTION**

All finished tax maps created under the provisions of legislation are the property of the Ritchie County Assessor and the reproduction, copying, distribution, sale, or lease of such tax maps or copies thereof without the written permission of the Ritchie County Assessor is prohibited by law.

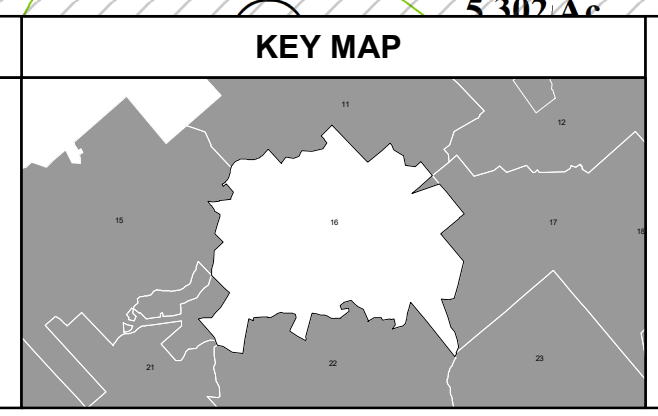

**Ritchie County**  
 Office of Assessor  
**HARRISVILLE, W.Va.**

**GRANT DISTRICT**  
 District : 05      Map No : 16

Date, Aerial Photography : N/A      Date, Map : 03/13/2024  
 Photo No : N/A      Scale : 1"=400'