

FOR TAX PURPOSES ONLY

Prepared By:
Max Cochran
 Webster County Assessor

Legend

Property Line	—	Original Lot Line	—
Road Right of Way	—	Lot Number	(15)
Corporation Line	—	Parcel Number	(99)
District Line	—	Water	—
County Line	—	Railroad	—

R	1	Revised 04/01/2018	9	17
O	2	Revised 01/22/2020	10	18
V	3	Revised 03/17/2021	11	19
I	4	Revised 01/22/2022	12	20
S	5	Revised 01/04/2023	13	21
I	6	Revised 01/22/2024	14	22
O	7	Revised 01/29/2025	15	23
N	8		16	24

STATE OF WEST VIRGINIA
COUNTY OF WEBSTER
 Office of Assessor

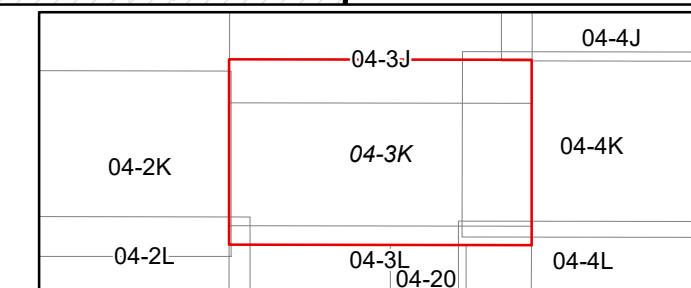

GLADE
 Map: 3K
 Date, Aerial Photography: 2003
 Date, Map: 1/30/2025
 Scale: 1" = 400'