

BRAXTON COUNTY
WEBSTER COUNTY



FOR TAX PURPOSES ONLY

Prepared By:
Max Cochran
Webster County Assessor

Legend

| | | | |
|-------------------|-------------------|---------------|------|
| Property Line | Original Lot Line | Lot Number | (15) |
| Road Right of Way | Corporation Line | Parcel Number | (99) |
| District Line | Water | Railroad | |
| County Line | | | |

| | | | | | |
|---|---|--------------------|----|--|----|
| R | 1 | Revised 04/01/2018 | 9 | | 17 |
| O | 2 | Revised 01/22/2020 | 10 | | 18 |
| V | 3 | Revised 03/17/2021 | 11 | | 19 |
| I | 4 | Revised 01/22/2022 | 12 | | 20 |
| S | 5 | Revised 01/04/2023 | 13 | | 21 |
| J | 6 | Revised 01/22/2024 | 14 | | 22 |
| O | 7 | Revised 01/22/2025 | 15 | | 23 |
| N | 8 | Revised 01/29/2025 | 16 | | 24 |

STATE OF WEST VIRGINIA
COUNTY OF WEBSTER
Office of Assessor

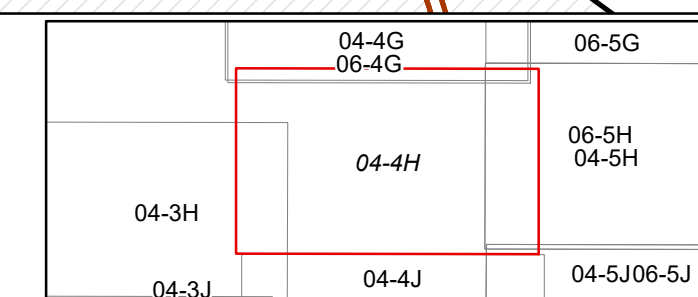

GLADE
Map: 4H

Date, Aerial Photography: 2003
Date, Map: 1/30/2025
Scale: 1" = 400'