

# Wood County

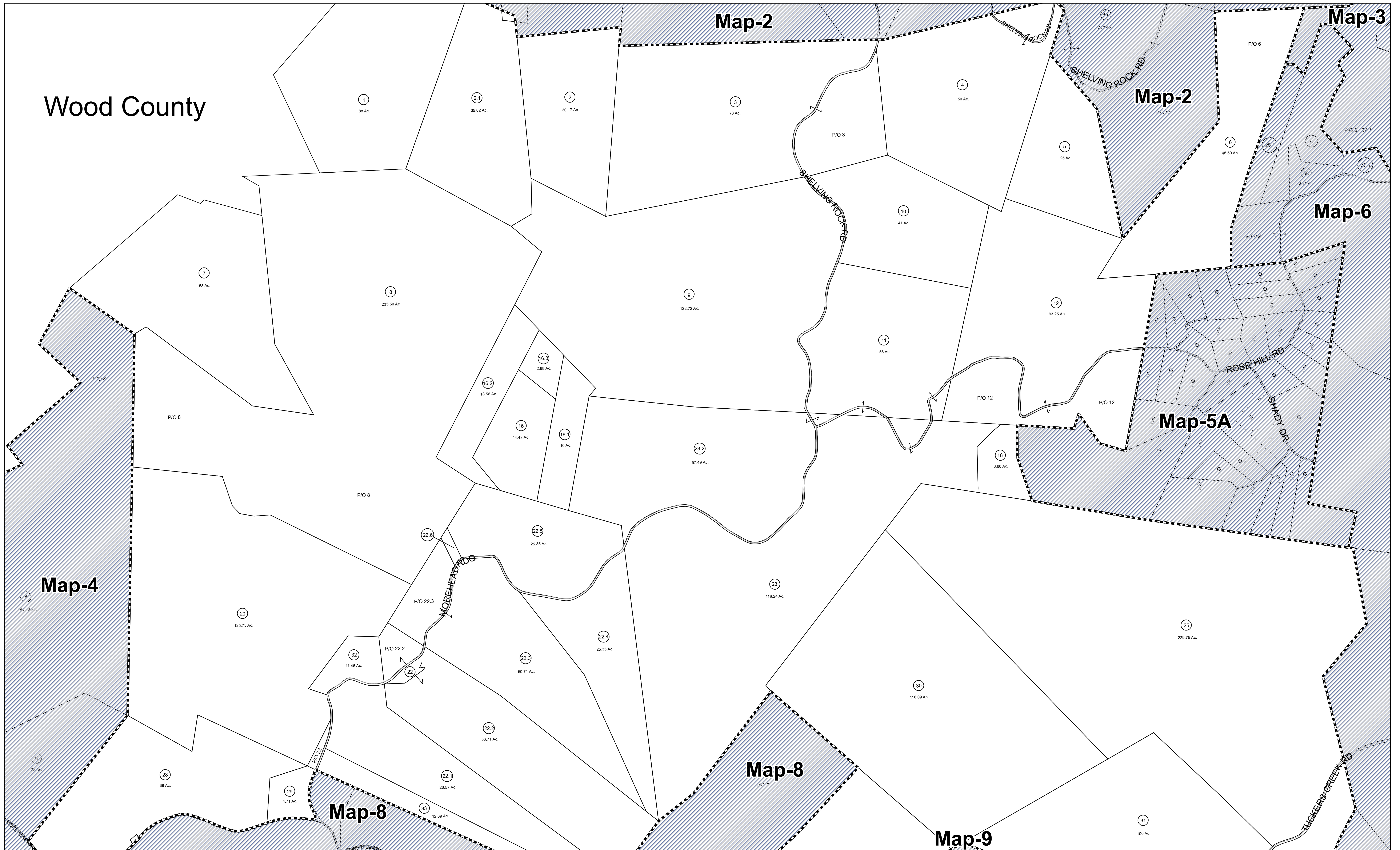

## FOR TAX PURPOSES ONLY

PREPARED BY

### WIRT COUNTY ASSESSORS OFFICE

All finished tax maps created by provision of West Virginia law and are the property of the county assessors who created them. The reproduction, copying, distribution, sale or lease of such maps or copies thereof without the written permission of the respective county assessor is prohibited by law

Legend	
Parcel Boundaries	Lot Number (15)
Lot Line	Parcel ID Number (125)
Leader Line	Block Number (A)
District Line	Stream
Railroad Center Line	Creek / River
Creek / River	Map Boundary

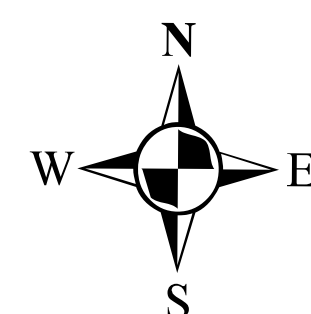

## WIRT COUNTY

Office of the Assessor

ELIZABETH, WEST VIRGINIA

Coordinate System: NAD 1983 2011 StatePlane West Virginia South FIPS 4702 FIPS  
 Projection: Lambert Conformal Conic  
 Datum: NAD 1983 2011  
 False Easting: 1,968,500.0000  
 False Northing: 0.0000  
 Central Meridian: -81.0000  
 Standard Parallel 1: 37.4833  
 Standard Parallel 2: 38.8833  
 Latitude Of Origin: 37.0000  
 Units: Foot US

## Tucker District

### Map No. 5

1 inch = 400 feet

Date Last Revised: 1/21/2020