

86-9-G
9-H

9-G 10-G
9-H 10-H

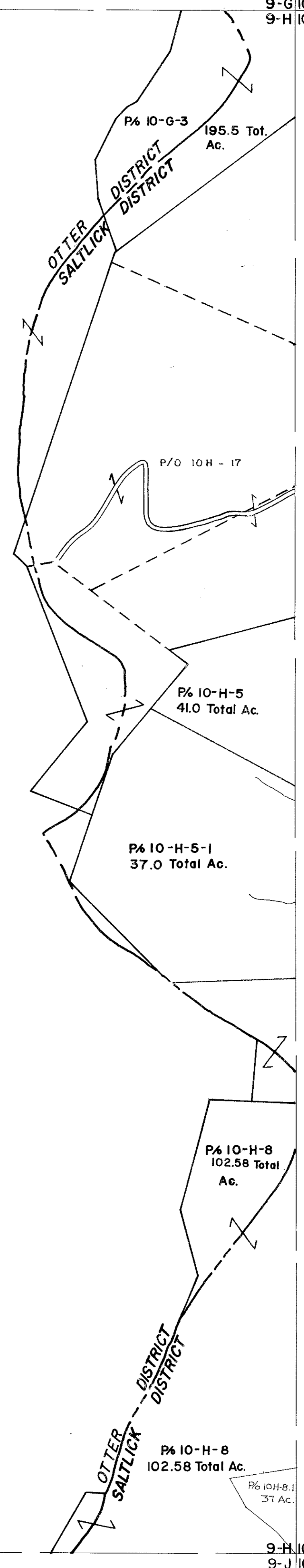

9-H
9-J

9-H 10-H
9-J 10-J

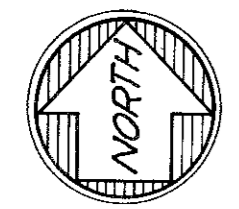

For Tax Purposes Only

Prepared by
VOGT, IVERS AND ASSOCIATES
 ENGINEERS-ARCHITECTS
 CHARLESTON, W.VA.
 CINCINNATI, OHIO

Property line ————
 Edge of pavement or roadway - - - -
 Corporation line - - - - -
 District line - - - - -
 County line - - - - -

Original lot line - - - - -
 Deed lot number (15)
 Parcel or index number (29)
 Improvement (o)
 Railroad

Revisions	
1	5-23-77 SRJ 9
2	NOVEMBER, 1981 TRL 10
3	JULY 1, 1983 11
4	7-1-84 L.E.S. 12
5	Revised to 7-1-84 TRL 13
6	July, 1987 TRL 14
7	5-1-97 J.E.B. 15
8	16

KEY MAP

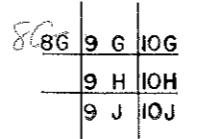

BRAXTON COUNTY

STATE OF WEST VIRGINIA

Office of Assessor

DISTRICT
SALT LICK DISTRICT

SHEET NO: 9-H

Date, Aerial Photography: 4-22-60 Date, Map: 4-24-62
 Photo No. BR-14-117 Scale: 1" = 400'