

FOR TAX PURPOSES ONLY
LANDMARK
 geospatial
A Division of Landmark Forestry LLC

Legend

	District Boundary		Deed lot Number (15)
	Previous Deed		Parcel or Index Number
	Property		Unknown
	Road Easement		Improvement
	Railroad Right of Way		Cemetery
	Road Right of Way		Church
	River		Educational
	Jeep Trail		

Restriction

All tax maps created under the provisions of reappraisal legislation are the property of the Assessor of Clay County, West Virginia and the reproduction, copying, modification, distribution or sale of such tax maps or any copies thereof without the written permission of the Clay County Assessor is prohibited by law.

Revisions

1	LANDMARK	09/2013	10	19	28
2			11	20	29
3			12	21	30
4			13	22	31
5			14	23	32
6			15	24	33
7			16	25	34
8			17	26	35
9			18	27	36

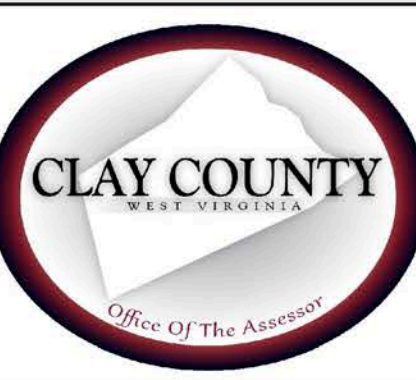
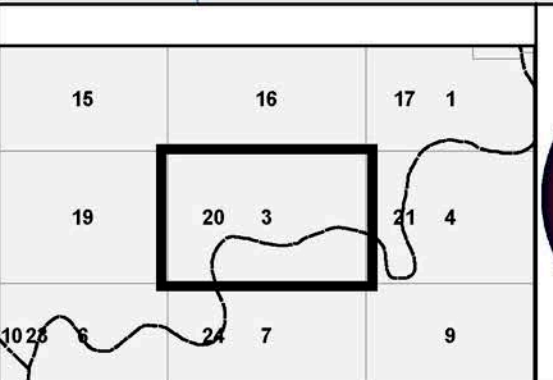

CLAY COUNTY
 Assessor's Office
 Teresa Lane, Assessor
 CLAY, WV

OTTER
 District 04 Map No. 20
 Date of Publication: 2/5/2014
 Scale: 1"=400'