

FOR TAX PURPOSES ONLY
LANDMARK
 geospatial
A Division of Landmark Forestry LLC

| Legend | | |
|--------|-----------------------|-------------|
| | District Boundary | (15) |
| | Previous Deed | (9) |
| | Property | Unknown |
| | Road Easement | Improvement |
| | Railroad Right of Way | Cemetery |
| | Road Right of Way | Church |
| | River | Educational |
| | Jeep Trail | |

Restriction

All tax maps created under the provisions of reappraisal legislation are the property of the Assessor of Clay County, West Virginia and the reproduction, copying, modification, distribution or sale of such tax maps or any copies thereof without the written permission of the Clay County Assessor is prohibited by law.

| Revisions | | | | | |
|-----------|----|----|----|--|--|
| 1 | 10 | 19 | 28 | | |
| 2 | 11 | 20 | 29 | | |
| 3 | 12 | 21 | 30 | | |
| 4 | 13 | 22 | 31 | | |
| 5 | 14 | 23 | 32 | | |
| 6 | 15 | 24 | 33 | | |
| 7 | 16 | 25 | 34 | | |
| 8 | 17 | 26 | 35 | | |
| 9 | 18 | 27 | 36 | | |

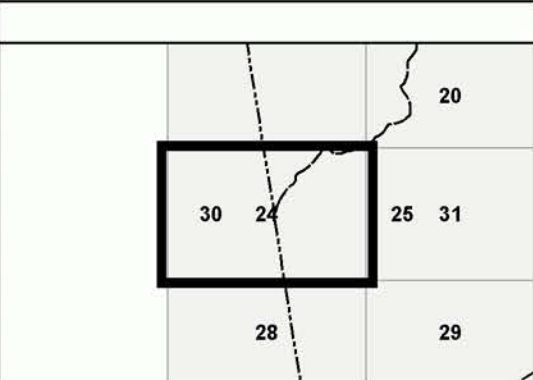

CLAY COUNTY
 Assessor's Office
 Teresa Lane, Assessor
 CLAY, WV

PLEASANT
 District 05 Map No. 24
 Date of Publication: 2/4/2015
 Scale: 1"=400'