



FOR TAX PURPOSES ONLY
LANDMARK
 geospatial
A Division of Landmark Forestry LLC

Legend		
-----	District Boundary	
- - - - -	Previous Deed	
-----	Property	
-----	Road Easement	
-----	Railroad Right of Way	
-----	Road Right of Way	
-----	River	
-----	Jeep Trail	
⑨	Deed lot Number	(15)
⑨	Parcel or Index Number	
Ⓜ	Unknowns	
○	Improvement	
Ⓜ	Cemetery	
Ⓜ	Church	
Ⓜ	Educational	

Restriction

All tax maps created under the provisions of reappraisal legislation are the property of the Assessor of Clay County, West Virginia and the reproduction, copying, modification, distribution or sale of such tax maps or any copies thereof without the written permission of the Clay County Assessor is prohibited by law.

		Revisions			
1	LANDMARK 01/2014	10	19	28	
2		11	20	29	
3		12	21	30	
4		13	22	31	
5		14	23	32	
6		15	24	33	
7		16	25	34	
8		17	26	35	
9		18	27	36	

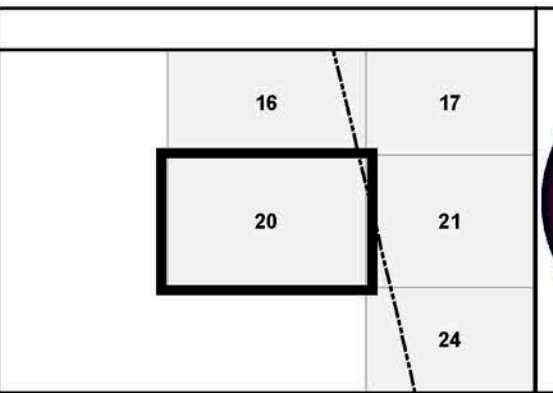

CLAY COUNTY
 Assessor's Office
 Teresa Lane, Assessor
 CLAY, WV

UNION
 District 06 Map No. 20
 Date of Publication: 2/5/2014
 Scale: 1"=400'