

FOR TAX PURPOSES ONLY
LANDMARK
 geospatial
A Division of Landmark Forestry LLC

Legend	
	District Boundary
	Previous Deed
	Property
	Road Easement
	Railroad Right of Way
	Road Right of Way
	River
	Dead lot Number (15)
	Parcel or Index Number (9)
	Unknown
	Improvement
	Cemetery
	Church
	Educational

Restriction

All tax maps created under the provisions of reappraisal legislation are the property of the Assessor of Gilmer County, West Virginia and the reproduction, copying, modification, distribution or sale of such tax maps or any copies thereof without the written permission of the Gilmer County Assessor is prohibited by law.

Revisions					
1	11/18/1963	10	19	28	
2	DF 7/1/1981	11	20	29	
3	NCS 7/1/1987	12	21	30	
4	TLB 1/1/1989	13	22	31	
5	HD 4/1/1995	14	23	32	
6	JEB 4/1/1996	15	24	33	
7	REK 4/27/2000	16	25	34	
8		17	26	35	
9		18	27	36	

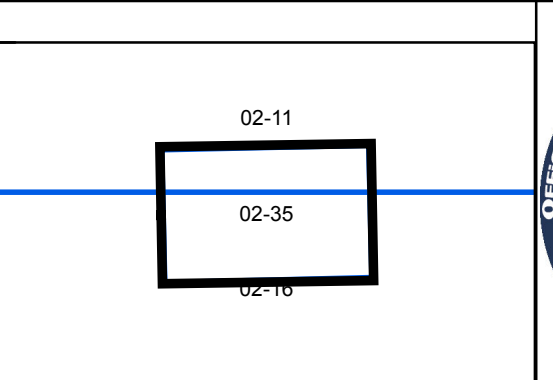

GILMER COUNTY
 Assessor's Office
 Melissa Jedamski, Assessor
 GLENVILLE, WV

DE KALB
 District 02 Map No. 35
 Date of Publication: 2/13/2019
 Scale: 1"=100'