

FOR TAX PURPOSES ONLY  
**LANDMARK**  
 geospatial  
A Division of Landmark Forestry LLC

Legend	
	District Boundary
	Previous Deed
	Property
	Road Easement
	Railroad Right of Way
	Road Right of Way
	River
	Dead lot Number (15)
	Parcel or Index Number (9)
	Unknown
	Improvement
	Cemetery
	Church
	Educational

**Restriction**

All tax maps created under the provisions of reappraisal legislation are the property of the Assessor of Gilmer County, West Virginia and the reproduction, copying, modification, distribution or sale of such tax maps or any copies thereof without the written permission of the Gilmer County Assessor is prohibited by law.

Revisions	
1	11/23/1963
2	SLS INC-JWM 4/2/1998
3	REK 4/27/2000
4	H & S 6/7/2004
5	S & H 6/9/2006
6	RAS 7/1/1965
7	TG 11/18/1974
8	DS 10/30/1975
9	SRJ 4/20/1977
10	TRL 7/1/1981
11	RLB 7/1/1985
12	DF 7/1/1987
13	JEB 4/19/1993
14	
15	
16	
17	
18	
19	
20	
21	
22	
23	
24	
25	
26	
27	
28	
29	
30	
31	
32	
33	
34	
35	
36	

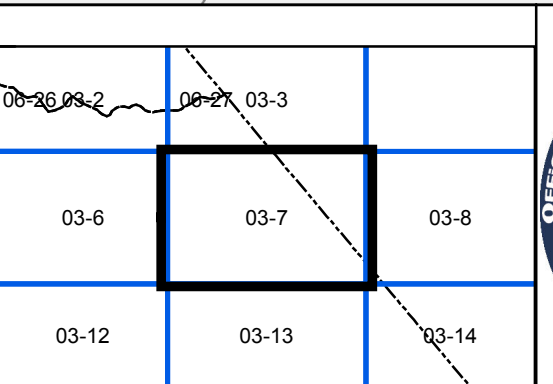

**GILMER COUNTY**  
 Assessor's Office  
 Melissa Jedamski, Assessor  
 GLENVILLE, WV

**GLENVILLE**  
 District 03 Map No. 7  
 Date of Publication: 2/13/2019  
 Scale: 1"=400'