

**FOR TAX PURPOSES ONLY**  
**LANDMARK**  
 geospatial  
A Division of Landmark Forestry LLC

Legend	
	District Boundary
	Previous Deed
	Property
	Road Easement
	Railroad Right of Way
	Road Right of Way
	River
	Dead lot Number (15)
	Parcel or Index Number (9)
	Unknown
	Improvement
	Cemetery
	Church
	Educational

**Restriction**

All tax maps created under the provisions of reappraisal legislation are the property of the Assessor of Gilmer County, West Virginia and the reproduction, copying, modification, distribution or sale of such tax maps or any copies thereof without the written permission of the Gilmer County Assessor is prohibited by law.

Revisions					
1	11/23/1963	10	S & H 5/22/2005	19	
2	DF 1/1/1989	11	RAS 7/1/1965	20	
3	JEB 4/19/1993	12	TG 11/18/1974	21	
4	JEB 4/1/1996	13	TG 11/3/1975	22	
5	SLS INC-DSW 4/13/1994	14	SRJ 4/22/1977	23	
6	REK 4/27/2000	15	DF 7/1/1981	24	
7	REK 5/2/2002	16	DF 7/1/1983	25	
8	S & H 4/20/2003	17	RLB 7/1/1984	26	
9	H & S 6/7/2004	18	DF 7/1/1987	27	
				28	
				29	
				30	
				31	
				32	
				33	
				34	
				35	
				36	

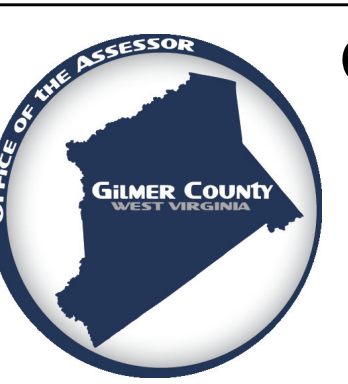
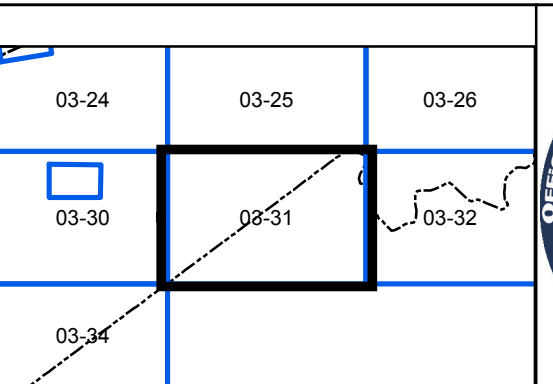

**GILMER COUNTY**  
 Assessor's Office  
 Melissa Jedamski, Assessor  
 GLENVILLE, WV

**GLENVILLE**  
 District 03 Map No. 31  
 Date of Publication: 2/13/2019  
 Scale: 1"=400'