

FOR TAX PURPOSES ONLY
LANDMARK
 geospatial
A Division of Landmark Forestry LLC

Legend	
	District Boundary
	Previous Deed
	Property
	Road Easement
	Railroad Right of Way
	Road Right of Way
	River
	Dead lot Number (15)
	Parcel or Index Number (9)
	Unknown
	Improvement
	Cemetery
	Church
	Educational

Restriction

All tax maps created under the provisions of reappraisal legislation are the property of the Assessor of Gilmer County, West Virginia and the reproduction, copying, modification, distribution or sale of such tax maps or any copies thereof without the written permission of the Gilmer County Assessor is prohibited by law.

Revisions		
1	4/24/1963	10
2	REK 4/27/2000	11
3	REK 4/29/2002	12
4	S8H 6/9/2006	13
5	DAE 11/18/1974	14
6	DS 10/29/1975	15
7	DF 7/1/1981	16
8	NCS 7/1/1982	17
9	RLB 7/1/1985	18
10	CP 7/1/1987	19
11	DF 1/1/1989	20
12	SAJ 5/6/1994	21
13		22
14		23
15		24
16		25
17		26
18		27
19		28
20		29
21		30
22		31
23		32
24		33
25		34
26		35
27		36

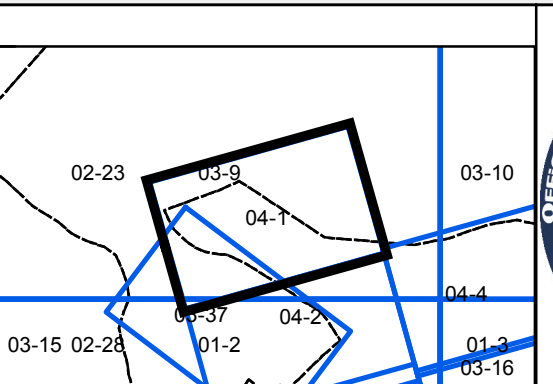

GILMER COUNTY
 Assessor's Office
 Melissa Jedamski, Assessor
 GLENVILLE, WV

GLENVILLE CORP
 District 04 Map No. 1
 Date of Publication: 2/13/2019
 Scale: 1"=100'