

FOR TAX PURPOSES ONLY

LANDMARK geospatial
A Division of Landmark Forestry LLC

Legend	
	District Boundary
	Previous Deed
	Property
	Road Easement
	Railroad Right of Way
	Road Right of Way
	River
	Dead lot Number (15)
	Parcel or Index Number (9)
	Unknown
	Improvement
	Cemetery
	Church
	Educational

Restriction

All tax maps created under the provisions of reappraisal legislation are the property of the Assessor of Gilmer County, West Virginia and the reproduction, copying, modification, distribution or sale of such tax maps or any copies thereof without the written permission of the Gilmer County Assessor is prohibited by law.

Revisions			
1	7/1/1984	10	JEB 4/1/1996
2	JWM 3/27/1998	11	
3	RLB 7/1/1985	12	
4	DF 7/1/1986	13	
5	CP 7/1/1987	14	
6	DF 1/1/1989	15	
7	DF 7/1/1989	16	
8	SAJ 5/6/1994	17	
9	HD 4/1/1995	18	
19		28	
20		29	
21		30	
22		31	
23		32	
24		33	
25		34	
26		35	
27		36	

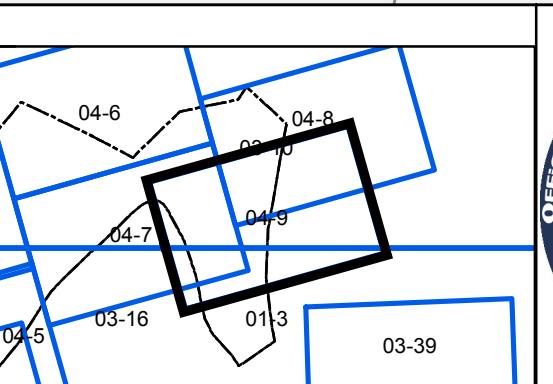

GILMER COUNTY
Assessor's Office
Melissa Jedamski, Assessor
GLENVILLE, WV

GLENVILLE CORP
District 04 Map No. 9
Date of Publication: 2/13/2019
Scale: 1"=100'