

GLENVILLE DISTRICT

FOR TAX PURPOSES ONLY
LANDMARK
 geospatial
A Division of Landmark Forestry LLC

Legend	
	District Boundary
	Previous Deed
	Property
	Road Easement
	Railroad Right of Way
	Road Right of Way
	River
	Parcel or Index Number
	Unknown
	Improvement
	Cemetery
	Church
	Educational

Restriction

All tax maps created under the provisions of reappraisal legislation are the property of the Assessor of Gilmer County, West Virginia and the reproduction, copying, modification, distribution or sale of such tax maps or any copies thereof without the written permission of the Gilmer County Assessor is prohibited by law.

Revisions			
1	DAE 11/19/1974	10	DS 10/30/1975
2	NK 4/4/1992	11	SRJ 4/18/1977
3	JEB 4/19/1991	12	DF 7/1/1981
4	SAJ 5/6/1994	13	CP 7/1/1983
5	JEB 4/1/1996	14	RLB 7/1/1985
6	SLS INC. - JWM 4/1/1995	15	DF 7/1/1986
7	REK 4/27/2000	16	CP 7/1/1987
8	REK 5/15/2001	17	NGK 1/12/1991
9	H & S 6/7/2004	18	
		19	
		20	
		21	
		22	
		23	
		24	
		25	
		26	
		27	
		28	
		29	
		30	
		31	
		32	
		33	
		34	
		35	
		36	

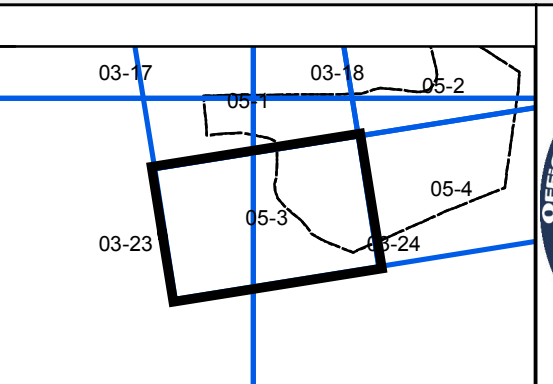

GILMER COUNTY
 Assessor's Office
 Melissa Jedamski, Assessor
 GLENVILLE, WV

SAND FORK CORP
 District 05 Map No. 3
 Date of Publication: 2/13/2019
 Scale: 1"=100'