

5

12

18

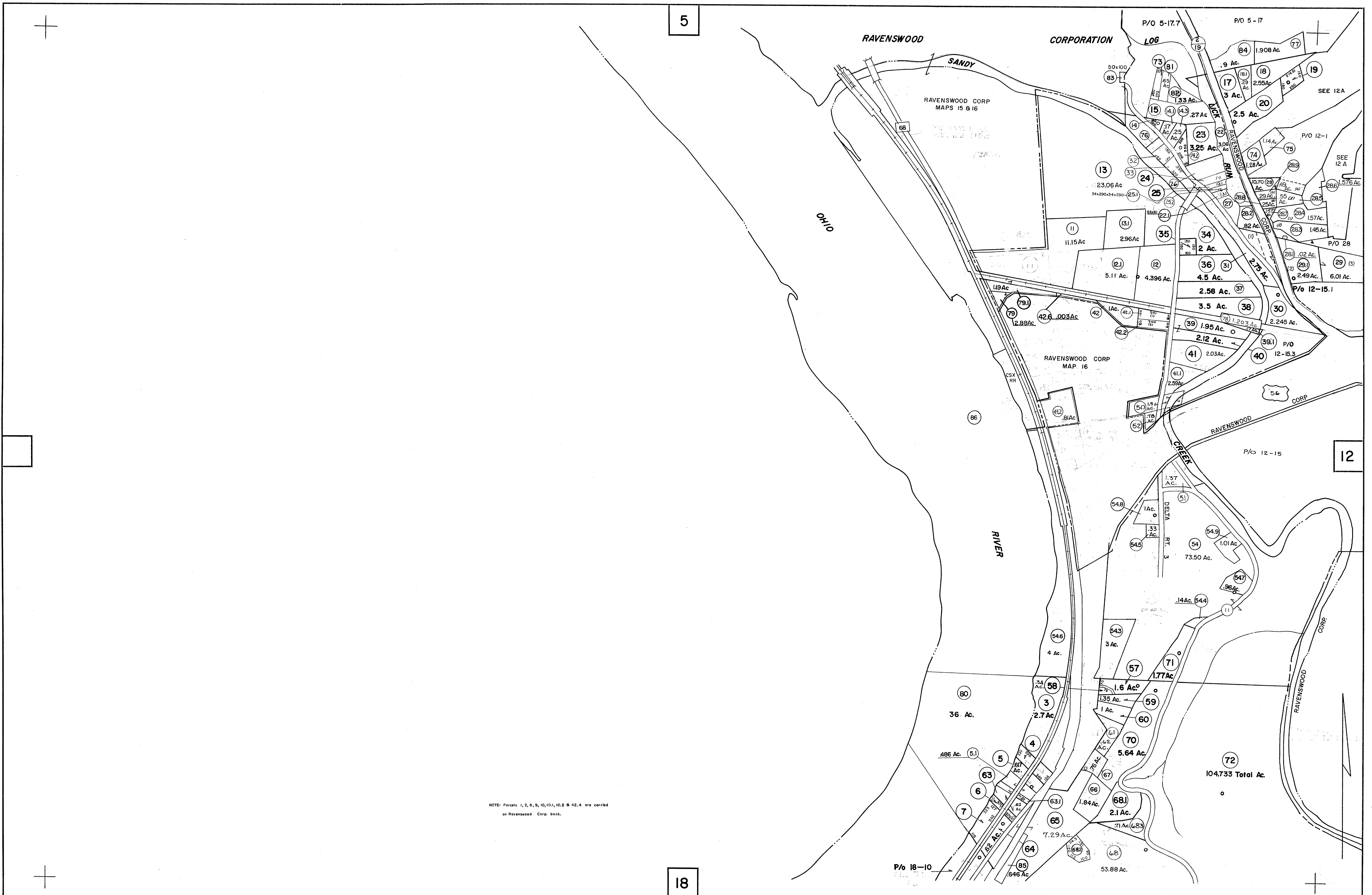

NOTE: Parcels 1, 2, 6, 9, 10, 10.1, 10.2 & 42.4 are carried on Ravenswood Corp. book.

FOR TAX PURPOSES ONLY

PREPARED BY
AERO SERVICE CORPORATION
210 E. COURTLAND STREET PHILADELPHIA, PENNA.

Legend	
Property line	-----
Edge of pavement or roadway	-----
Corporation line	-----
District line	-----
County line	-----
Original lot line
Deed lot number in parenthesis	(15)
Parcel or index number in circle	⊙
Improvement	○
Railroad	++++

Revisions	
1	JUNE 74 PAM 9 OGIS 3/5/92 DSH 17 6/15/04 S&H
2	1-27-76 BAH 10 OGIS 5/9/93 DSH 18 6-16-05 H&S
3	6/28/77 TJK 11 OGIS 3/22/94 DC 19 5/21/06 S&H
4	1/16/83 R.L.B. 12 O.G.I.S 3-13-95 J.E.B 20 5-13-07 H&S
5	7/1/85 R.L.B. 13 OGIS 4-97 HD 21 5/25/08 S&H
6	Revised to 7-1-86 R.L.B. 14 OGIS 5-98 HD 22 4-13-10 H&S
7	REV. TO 7-1-88 R.E.B. 15 4/15/2000 S&H 23 4-30-11 H&S
8	REV. TO 7-1-89 R.E.B. 16 4/21/2002 S&H 24 4-9-13 H&S

JACKSON COUNTY — WEST VIRGINIA
Office of Assessor

RAVENSWOOD DISTRICT
City — Town — District:
Map No: 11
Date, Aerial Photography: 11-26-62 Date, Map: 11-12-64
Photo No: 5-1607, 1608 5-1605, 1606 Scale: 1" = 400'
5-1606, 1607 6-1566, 1569