

114
122

114 115
122 123

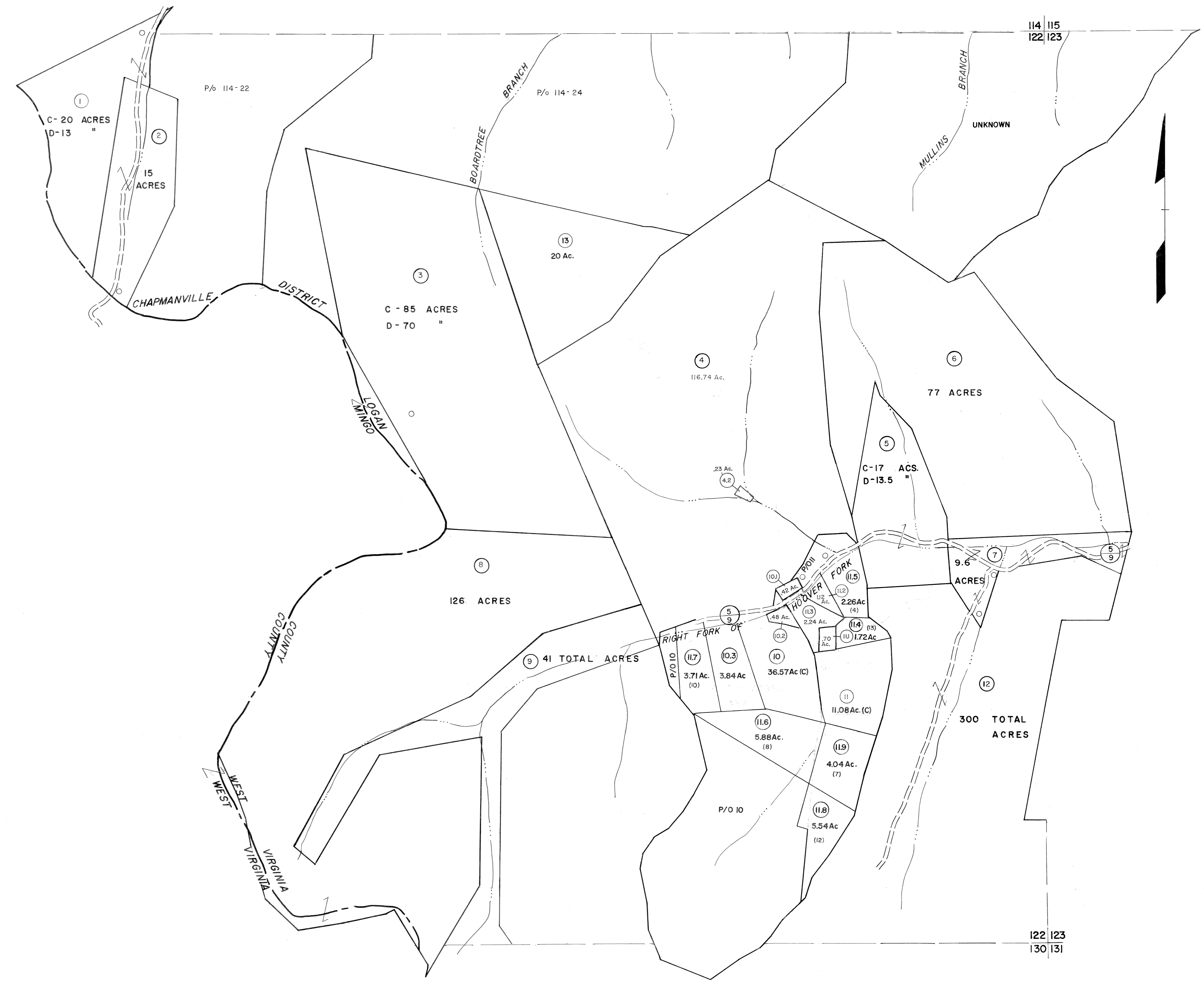

122
130

122 123
130 131

For Tax Purposes Only

Prepared by
MICHAEL BAKER, JR., INC.
Consulting Engineers
Rochester, Pennsylvania

Legend	
Property line	—————
Edge of pavement or roadway	———
Corporation line	—————
District line	—————
County line	—————
Original lot line	-----
Deed lot number	(15)
Parcel or index number	(29)
Improvement	o
Railroad	—+—+—+—

Revisions	
1	4-1-64
2	To 1-1-83 C.D.
3	7-1-88 TRL
4	7-1-02 TO 7-1-04 L.S.S.
5	4-15-08 H.S.
6	
7	
8	
9	
10	
11	
12	
13	
14	
15	
16	
17	
18	
19	
20	
21	
22	
23	
24	



LOGAN COUNTY
STATE OF WEST VIRGINIA
Office of Assessor

DISTRICT
GUYAN

SHEET NO: 122

Date, Aerial Photography: November, 1962 Date, Map: April, 1963
Photo No: Scale: 1" = 400'