

129|130  
139|140

130|  
140|

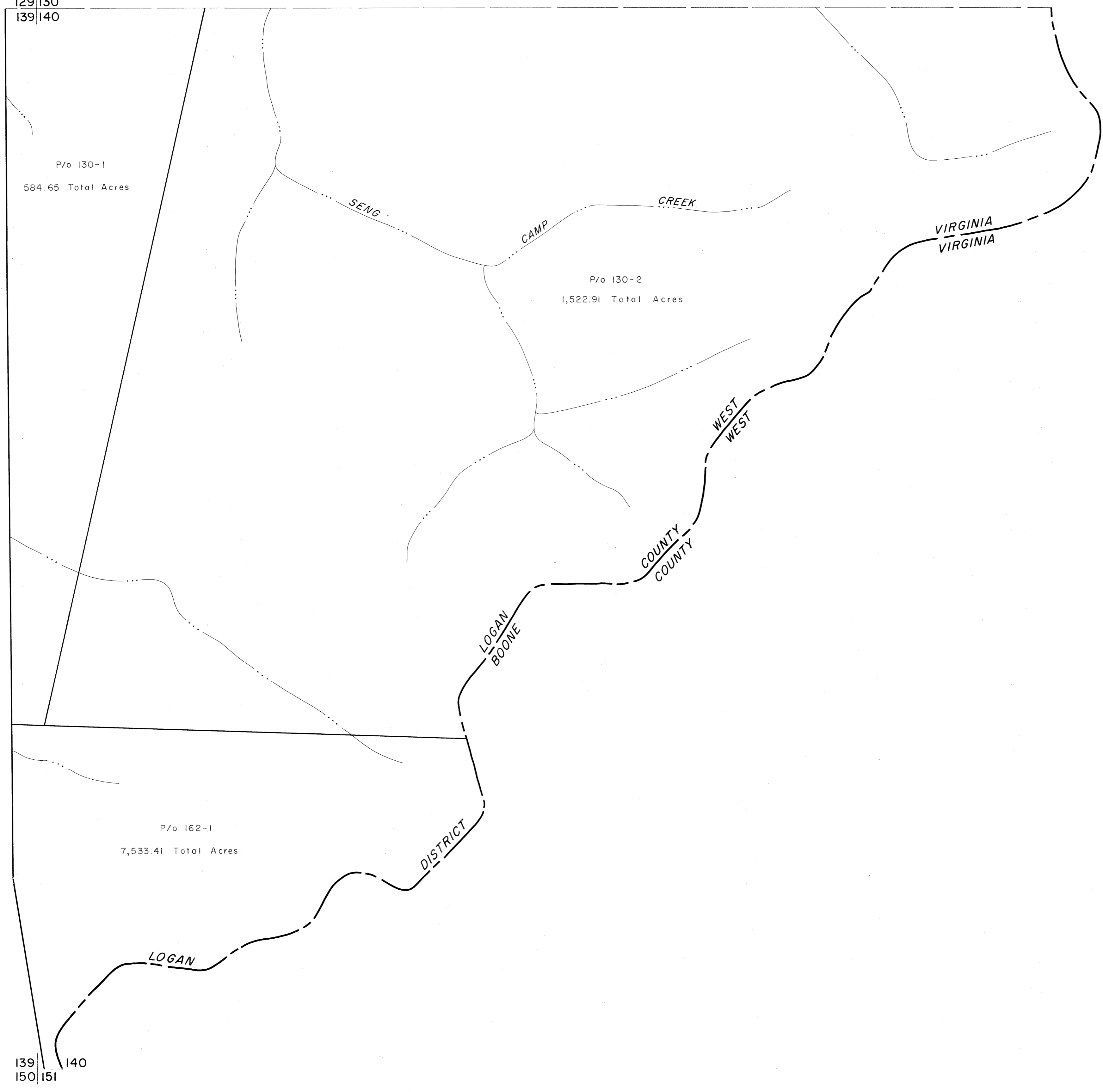

139|140  
150|151

140|  
151|

For Tax Purposes Only

Prepared by  
MICHAEL BAKER, JR., INC.  
Consulting Engineers  
Rochester, Pennsylvania

Legend	
Property line	—————
Edge of pavement or roadway	———
Corporation line	—————
District line	—————
County line	—————
Original lot line	-----
Dead lot number	(15)
Parcel or index number	(29)
Improvement	○
Railroad	—+—+—+—

Revisions			
1	4-1-64	9	17
2	TO JULY 1981 C.P.	10	18
3		11	19
4		12	20
5		13	21
6		14	22
7		15	23
8		16	24

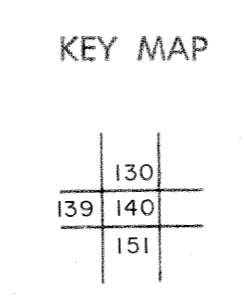

**LOGAN COUNTY**  
STATE OF WEST VIRGINIA  
Office of Assessor

DISTRICT **LOGAN**

**SHEET NO: 140**

Date, Aerial Photography: Nov., 1962      Date, Map: Apr., 1963  
Photo No:      Scale: 1" = 400'