

101 | 102  
107 | 108

102 | 103  
108 | 109

107 | 108  
117 | 118

108 | 109  
118 | 119

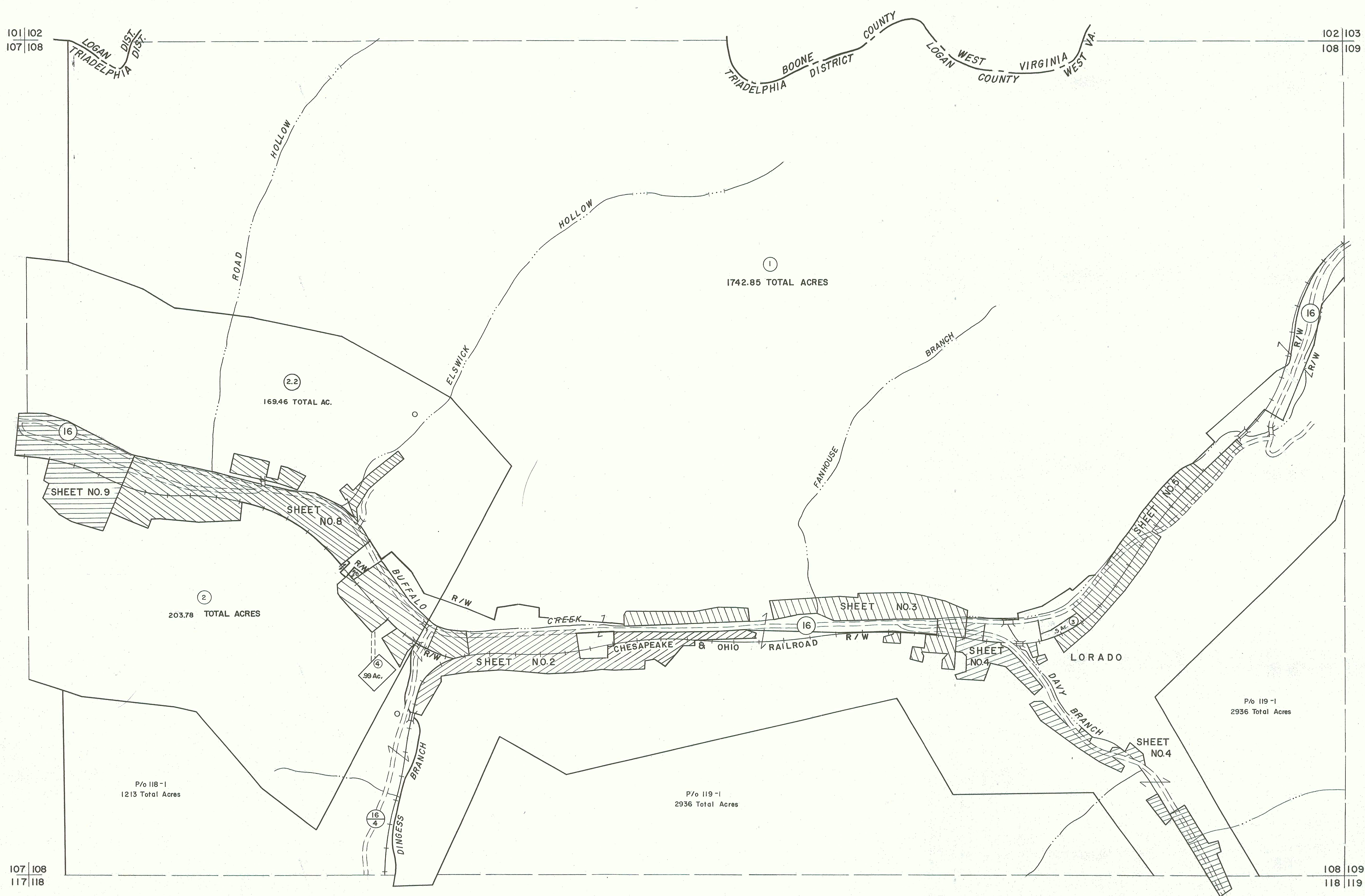

**For Tax Purposes Only**  
 Prepared by  
**MICHAEL BAKER, JR., INC.**  
 Consulting Engineers  
 Rochester, Pennsylvania

Legend	
Property line	—
Edge of pavement or roadway	—
Corporation line	—
District line	—
County line	—
Original lot line	—
Deed lot number	(15)
Parcel or index number	(2)
Improvement	o
Railroad	—

Revisions			
1	4-1-64	9	17
2	To 7-1-84 C.P.	10	18
3	July, 1986	TRL	19
4	Revised to 7-1-87		20
5	10/21/15	S&H	21
6			22
7			23
8			24

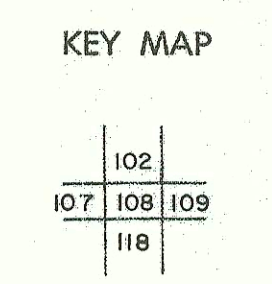

**LOGAN COUNTY**  
 STATE OF WEST VIRGINIA  
 Office of Assessor

DISTRICT **TRIADELPHIA**  
**SHEET NO: 108**  
 Date, Aerial Photography: November, 1962 Date, Map: April, 1963  
 Photo No: Scale: 1" = 400'