

106107  
116117

107108  
117118

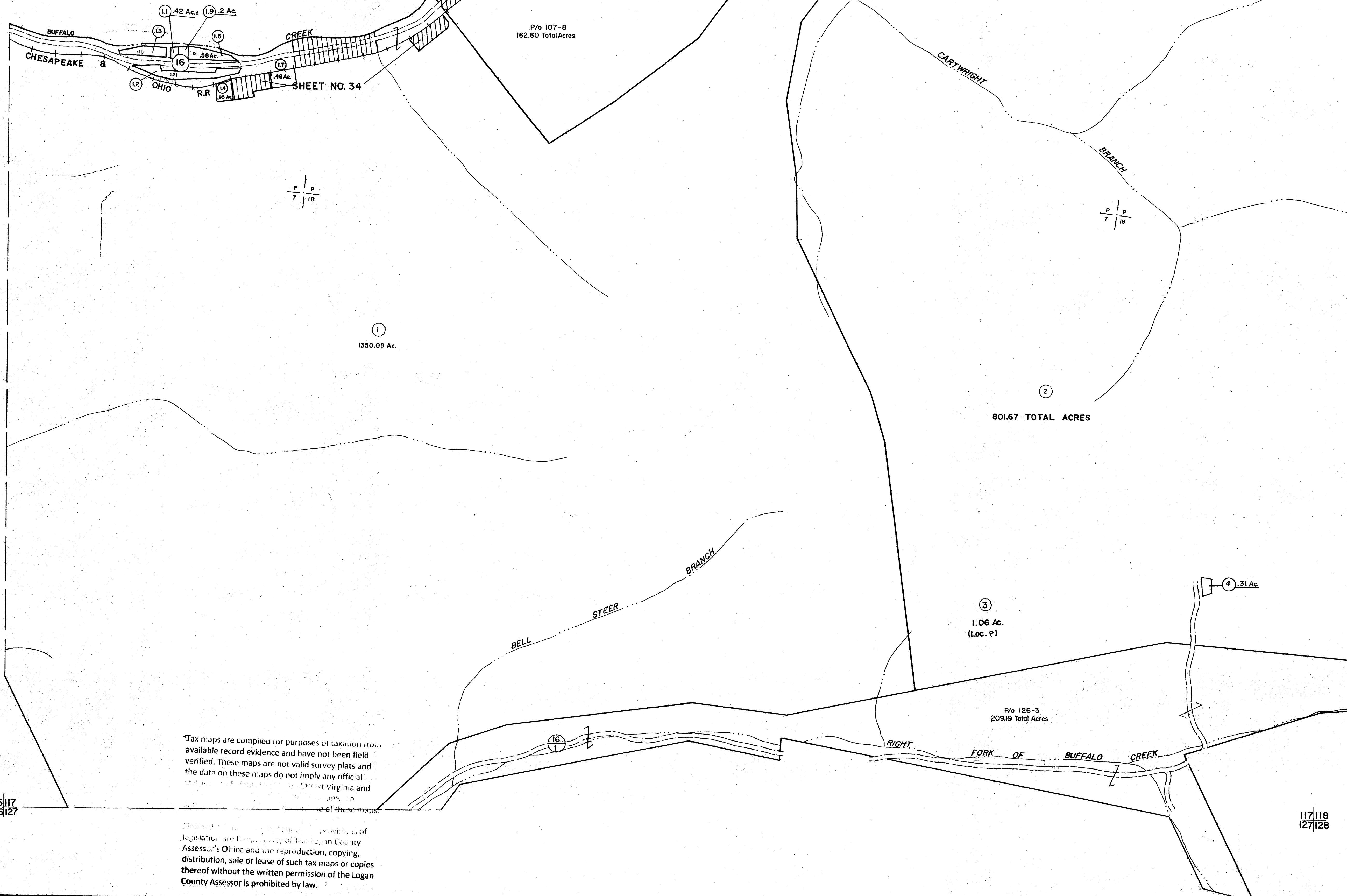

\*Tax maps are compiled for purposes of taxation from available record evidence and have not been field verified. These maps are not valid survey plats and the data on these maps do not imply any official responsibility on the part of the State of West Virginia and its Assessor's Office.

Printed and published by authority of the Board of Legislative Administration of the State of West Virginia. The Assessor's Office and the reproduction, copying, distribution, sale or lease of such tax maps or copies thereof without the written permission of the Logan County Assessor is prohibited by law.

116117  
126127

117118  
127128

**For Tax Purposes Only**  
Prepared by  
**MICHAEL BAKER, JR., INC.**  
Consulting Engineers  
Rochester, Pennsylvania

Legend	
Property line	Original lot line
Edge of pavement or roadway	Dead lot number
Corporation line	Parcel or index number
District line	Improvement
County line	Railroad

Revisions	
1	4-1-64
2	To 1-1-83 C.P.
3	Revised to 7/1/89 D.F.
4	OGIS 5/2/92 DSH
5	7-1-2000 J.E.B.
6	6-2-2003 J.E.B.
7	4-2016 C.M.
8	
9	

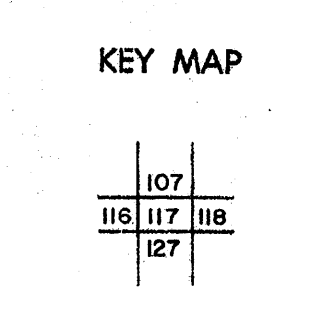

**LOGAN COUNTY**  
STATE OF WEST VIRGINIA  
Office of Assessor

DISTRICT **TRIADELPHIA**  
**SHEET NO: 117**  
Date, Aerial Photography: November, 1962 Date, Map: April, 1963  
Photo No. Scale: 1" = 400'