

STATE OF WEST VIRGINIA
STATE OF OHIO

STATE OF WEST VIRGINIA
STATE OF OHIO

FOR TAX PURPOSES ONLY

Prepared By:
Chris Kessler
Marshall County Assessor

Legend

Property Line	—	Original Lot Line	- - - - -
Road Right of Way	—	Lot Number (15)	(15)
Corporation Line	—	Parcel Number (99)	(99)
District Line	—	Water	—
County Line	—	Railroad	—

R	11	Revised 3/1/15	9	17
e	2		10	18
v	3		11	19
i	4		12	20
s	5		13	21
i	6		14	22
n	7		15	23
s	8		16	24

STATE OF WEST VIRGINIA
COUNTY OF MARSHALL
Office of Assessor

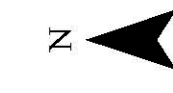
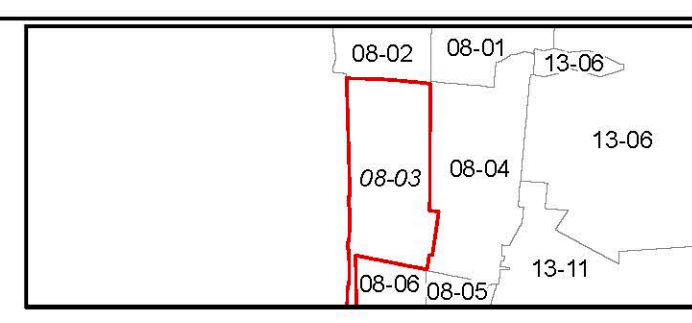

MCMECHEN CORP
Map: 3
Date, Aerial Photography: 2013
Date, Map: 3/25/2015
Scale: 1" = 100'