

393 394  
413 414

P/O 393-1

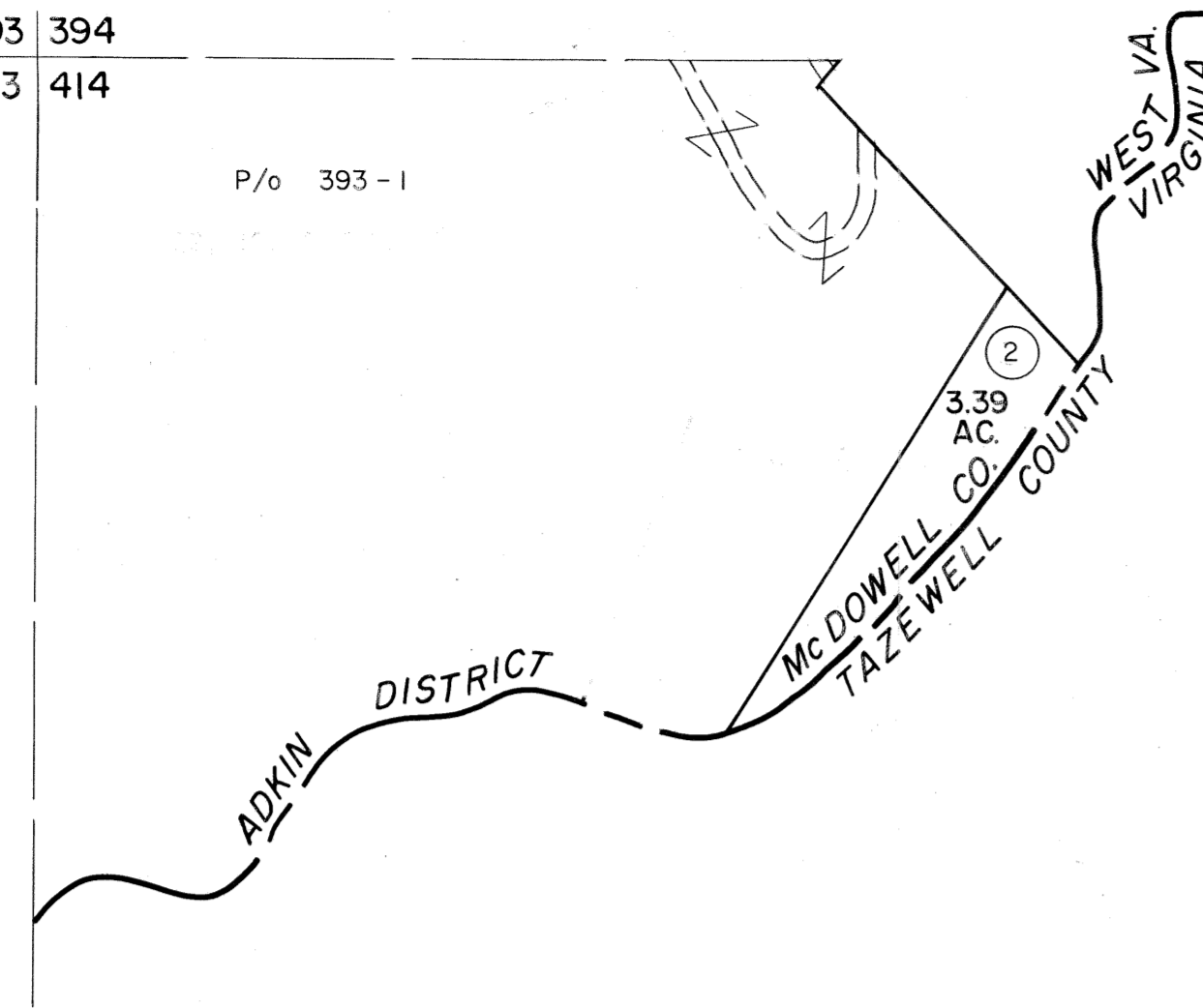

394 395  
414

413 414

414

**For Tax Purposes Only**

Prepared by  
**MICHAEL BAKER, JR., INC.**  
Consulting Engineers  
Rochester, Pennsylvania

**Legend**

Property line	—————	Original lot line	-----
Edge of pavement or roadway	-----	Deed lot number	(15)
Corporation line	-----	Parcel or index number	(2)
District line	-----	Improvement	o
County line	-----	Railroad	+

**Revisions**

1	4-15-64	9	17
2	To July 1983 C.P.	10	18
3	<i>JEB</i>	11	19
4	O.G. 1.S 12.1.96 JEB	12	20
5	5/23/04 S&H	13	21
6		14	22
7		15	23
8		16	24

**KEY MAP**

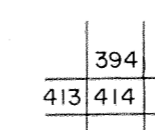

**MCDOWELL COUNTY**  
STATE OF WEST VIRGINIA  
Office of Assessor

DISTRICT

**ADKIN**

**SHEET NO: 414**

Date, Aerial Photography: April, 1961    Date, Map: July, 1962  
Photo No:    Scale: 1" = 400'