

FOR TAX PURPOSES ONLY
Prepared By
Mercer County Assessor's Office
Princeton, West Virginia

This tax map was compiled for the purpose of taxation from available record evidence and has not been field verified. This map is not a valid survey plat and the data on the map does not imply any official status to such data. The State of West Virginia and the Mercer County Assessor's Office assume no liability that might result from the use of this map.

Legend		
Property Line	Original Lot Line	-----
Road Right of Way	Lot Number	(15)
Corporation Line	Parcel Number	(99)
District Line	Water	-----
County Line	Railroad	-----

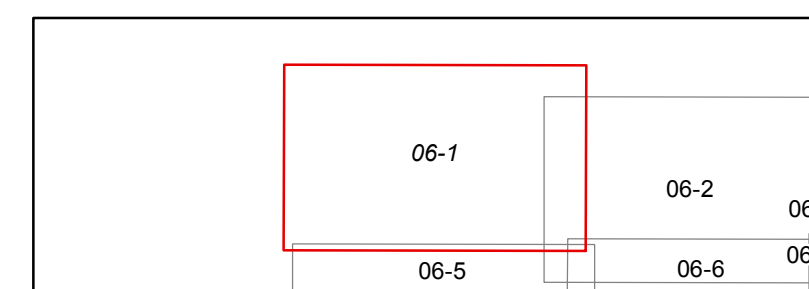

MERCER COUNTY
WEST VIRGINIA
Office of Assessor

RALEIGH COUNTY

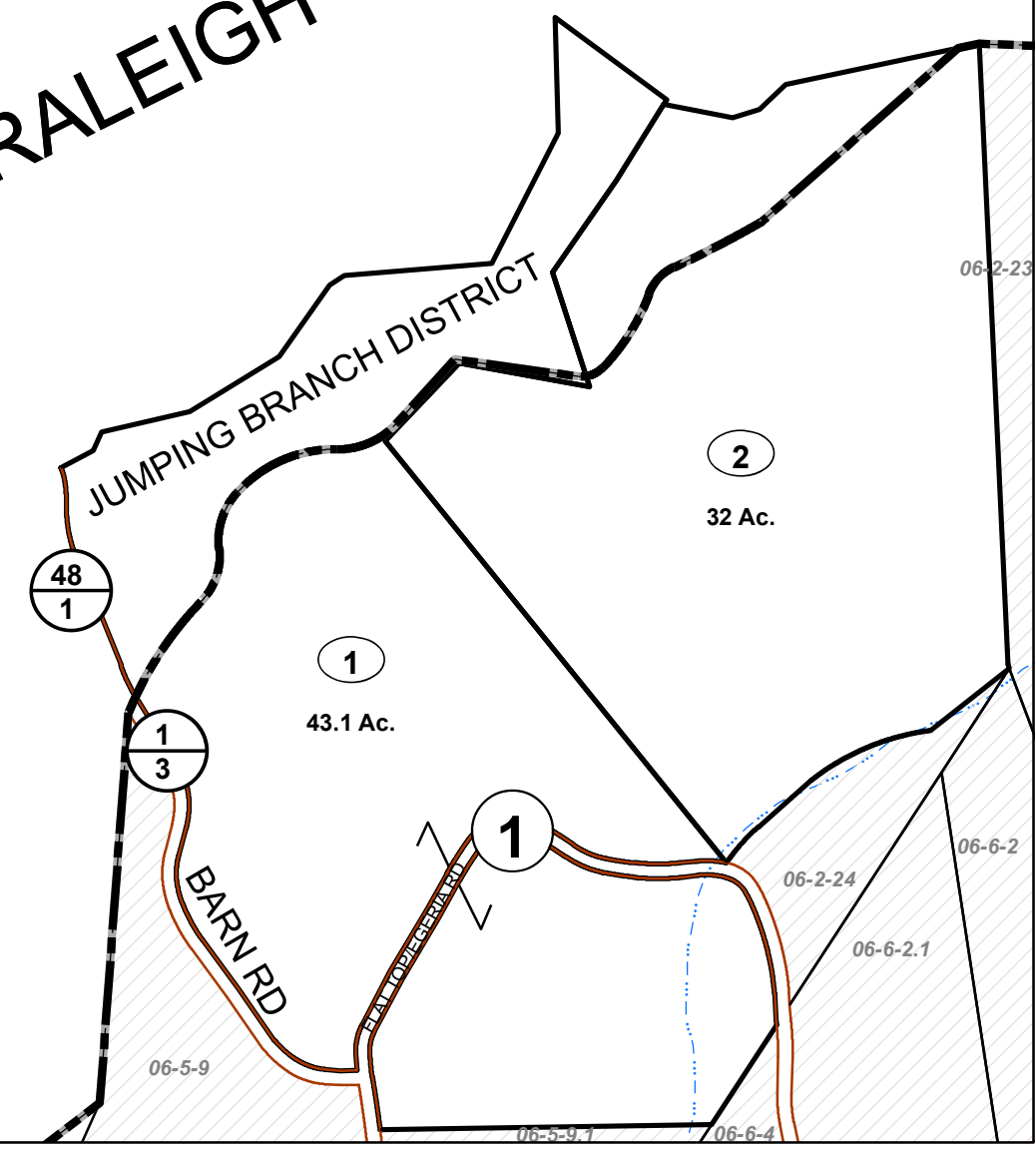

JUMPING BRANCH
Map: 1
Date, Aerial Photography: 2010
Date, Map: 9/10/2018
Scale: 1" = 400'