

09-454-1

80

RT 80 (60')

MEADOW STREET (30')

ORCHARD AVENUE (25')

GUYAN AVENUE (25')

MALLARD LOOP

CANE BRAKE BRANCH

09-454-13

09-455-

09-454-11

09-455-19

09-454-10

09-454-9.3

09-454-9.7

09-454-9.2

09-454-9.6

09-454-9.5

09-454-9.4

09-454-9.1

FOR TAX PURPOSES ONLY

Prepared By:

Ramona Mahon  
Mingo County Assessor

**Legend**

Property Line	Original Lot Line	Lot Number	(15)
Road Right of Way	Parcel Number	Water	(99)
Corporation Line	Water	Railroad	
District Line			
County Line			

R	11	Revised 1/1/18	9		17
O	2	Revised 1/31/19	10		18
V	3		11		19
I	4		12		20
S	5		13		21
I	6		14		22
O	7		15		23
N	8		16		24

STATE OF WEST VIRGINIA  
COUNTY OF MINGO  
Office of Assessor

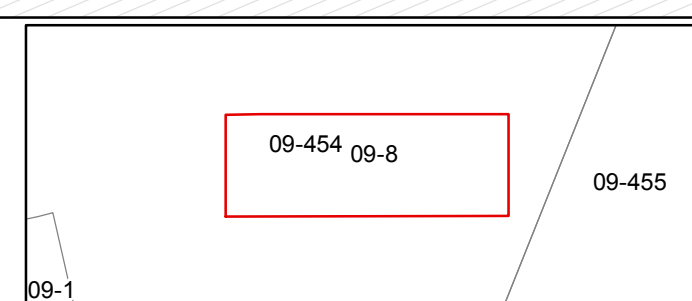

STAFFORD

Map: 8

Date, Aerial Photography: 2003

Date, Map: 2/5/2019

Scale: 1" = 100'