

FOR TAX PURPOSES ONLY

Prepared By:
Norb Netzel
 Monroe County Assessor

Legend

Property Line	—	Original Lot Line	- - - - -
Road Right of Way	—	Lot Number	(15)
Corporation Line	—	Parcel Number	(99)
District Line	- - - - -	Water	~ ~ ~ ~ ~
County Line	—	Railroad	+ + + + +

ASSESSED IN SPRINGS DISTRICT

R	1	Revised 3/1/15	9	17
G	2	Revised 3/1/16	10	18
V	3	Revised 12/30/2016	11	19
I	4	Revised 09/27/2017	12	20
S	5	Revised 01/25/2018	13	21
I	6	Revised 01/25/2019	14	22
O	7		15	23
N	8		16	24

STATE OF WEST VIRGINIA
COUNTY OF MONROE
 Office of Assessor

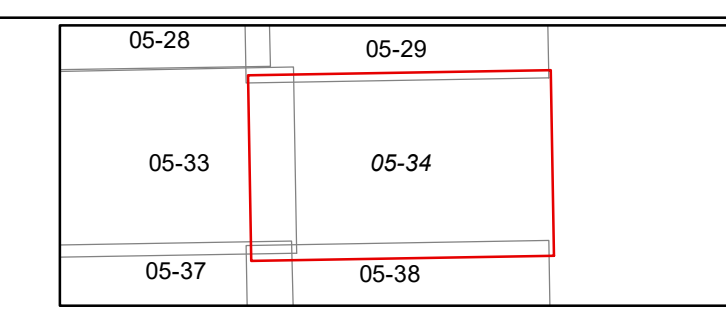

SPRINGFIELD
 Map: 34
 Date, Aerial Photography: 2003
 Date, Map: 1/25/2019
 Scale: 1" = 400'