

N

W

E

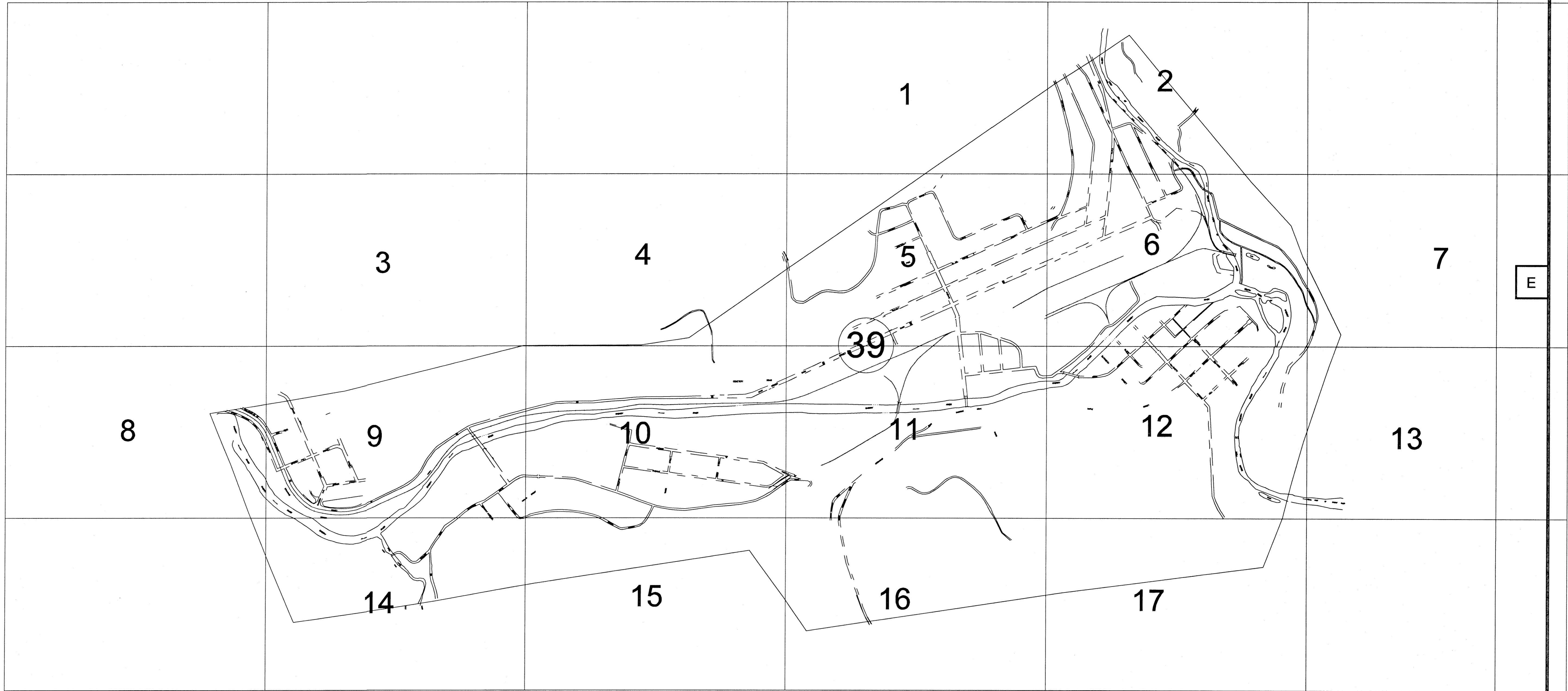

S

FOR TAX PURPOSE ONLY  
 PREPARED BY  
**ERNIE DENNISON**  
 NICHOLAS COUNTY ASSESSOR

Legend	
Property line	—————
Edge of pavement or roadway	—————
Corporation line	—————
District line	—————
County line	—————
Original lot line	.....
Deed lot number	(15)
Parcel or index number	99
Improvement	•
Railroad	+++++

Revisions	
1	1-26-2005 TER
2	
3	
4	
5	
6	
7	

NICHOLAS COUNTY - WEST VIRGINIA  
 Office of Assessor

**CITY OF RICHWOOD**  
 City - Town - District:  
**INDEX**  
 Map No: \_\_\_\_\_  
 Date, Aerial Photography: 4-20-61 Date, Map: 11-20-61  
 Photo No: \_\_\_\_\_ Scale: 1"=600"