

Map 5

Map 2

Map 4

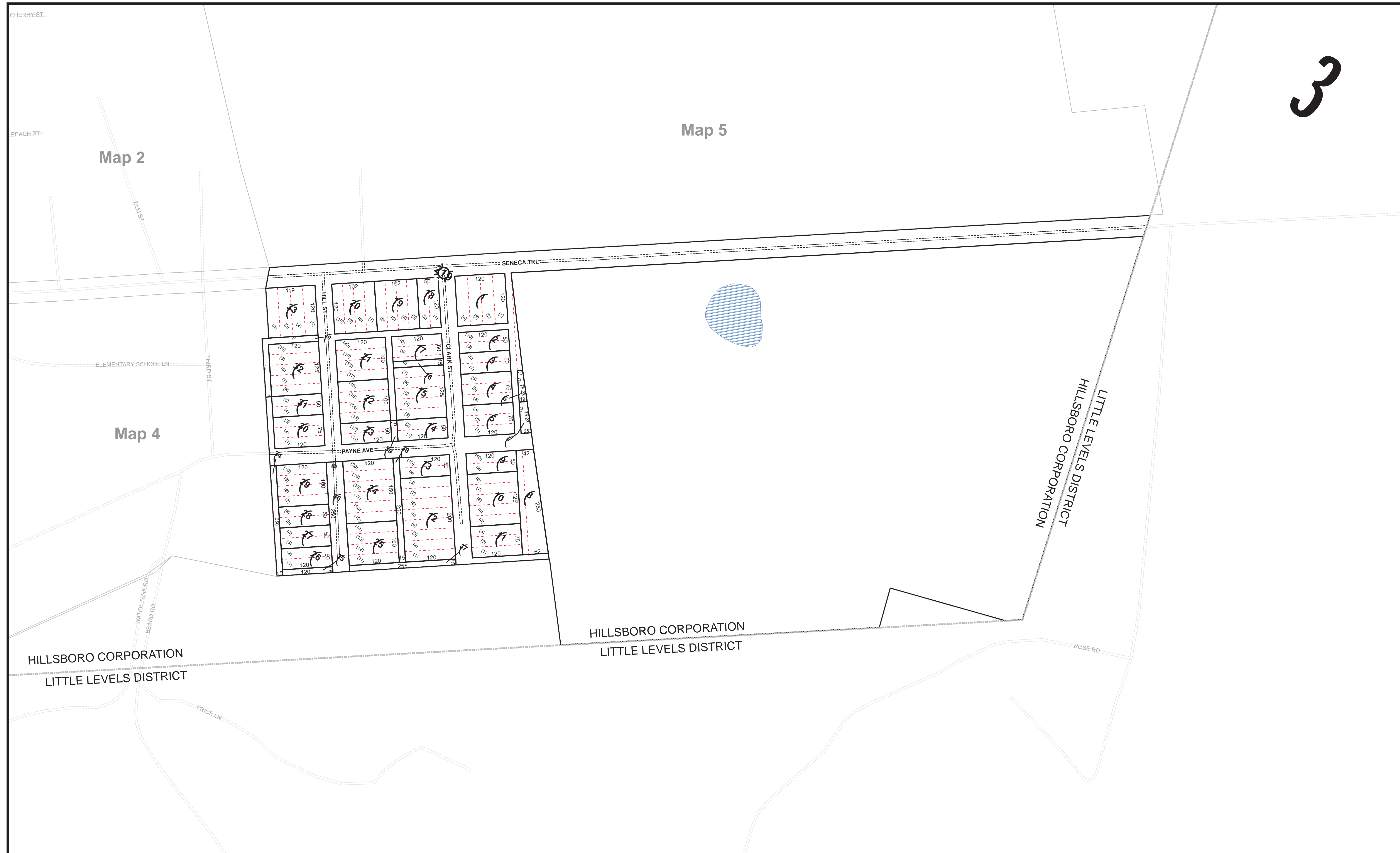

DISCLAIMER:
 This tax map was compiled solely for purposes of taxation from available record evidence and has not been field verified. This map is not suitable for legal, engineering or surveying purposes. The State of West Virginia and the Pocahontas County Assessor's Office assume no liability that might result from the use of this map.

LEGEND	
PARCELS	ROAD
CORPORATION LINE	RIGHT OF WAY
DISTRICT LINE	RAILROAD
LOT LINE	BRIDGE
MATCH LINE	LAND HOOK
STREAM	LAKE / POND
RIVER BANK	PARCEL NUMBER
LAKE / POND	LOT NUMBER

REVISIONS:	
1. June 1, 2012	8.
2. May 26, 2016	9.
3.	10.
4.	11.
5.	12.
6.	13.
7.	14.

RESTRICTIONS:
 All tax maps created under the provisions of reappraisal legislation are the property of the Pocahontas County Assessor's Office and the reproduction, copying, distribution or sale of such tax maps without the written permission of the State Tax Commissioner or the Assessor of Pocahontas County is prohibited by law.

**STATE OF WEST VIRGINIA
 COUNTY OF POCAHONTAS**
 OFFICE OF ASSESSOR
 900 10TH AVENUE
 MARLINTON, WV 24954
 Prepared on January 30, 2017

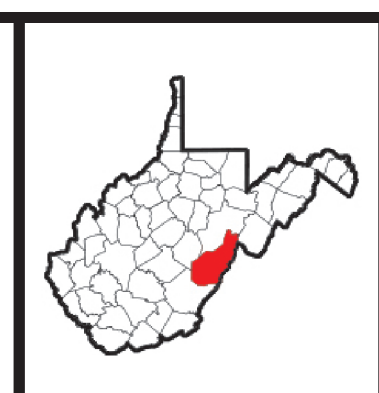

Hillsboro Corporation
 District No. 05 Map No. 6
Scale: 1:1,200

0 105 210 420 Feet

