

17
1 Ac.

BALTIMORE & OHIO RAILROAD RIGHT OF WAY

BALTIMORE & OHIO RAILROAD

FOR TAX PURPOSES ONLY
Prepared By:
Connie Ervin
Preston County Assessor

Parcel Line Right-of-Way Lot Line Parcel Hook
Rail Road Easement Parcel Number Stream

PRESTON COUNTY - WEST VIRGINIA
Restriction
Reproduction of Tax Maps Prohibited by Law
No person may reproduce, modify, copy, distribute or sell copies of tax maps prepared by the county without having first obtained written permission of the County Assessor

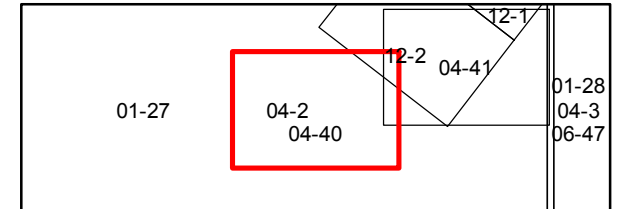

District: 04 Reno
Map No: 40
Date: 01/30/2019
Scale: 1" = 100'