

PREPARED BY
THE MAPPING / GIS STAFF OF:
SHERRY L. HAYES
PUTNAM COUNTY ASSESSOR
3389 WINFIELD ROAD
WINFIELD, WV 25213
PHONE: (304) 586-0206
FAX: (304) 586-0226

Date: 1/2/2019

FOR TAX PURPOSES ONLY
ALL TAX MAPS CREATED UNDER THE PROVISIONS OF REAPPRAISAL LEGISLATION ARE THE PROPERTY OF PUTNAM COUNTY WEST VIRGINIA AND THE REPRODUCTION, COPYING, DISTRIBUTION OR SALE OF SUCH TAX MAPS OR ANY COPIES THEREOF WITHOUT THE WRITTEN PERMISSION OF THE PUTNAM COUNTY ASSESSOR IS PROHIBITED BY LAW.

LEGEND	
— Road ROW	— Parcel Hook
— Parcel Boundary	— Lot line/Easement
— Road-Rail ROW	— Parcel-Road ROW
— District	— MapBooks
— Rivers/Lakes	— Utility_Easement
	23 Parcel Number
	001 Routing Number
	(12) Deed Lot Number

Revisions	
1.	1/03/2019 UPDATE SUPPLIED TO STATE (JSH)
2.	11/06/2013 UPDATE SUPPLIED TO STATE (PAW)
3.	1/14/2015 UPDATE SUPPLIED TO STATE (BAS)
4.	1/7/2016 UPDATE SUPPLIED TO STATE (BAS)
5.	1/7/2017 UPDATE SUPPLIED TO STATE (BAS)
6.	2/14/2017
7.	1/8/18 UPDATE SUPPLIED TO STATE (JSH)

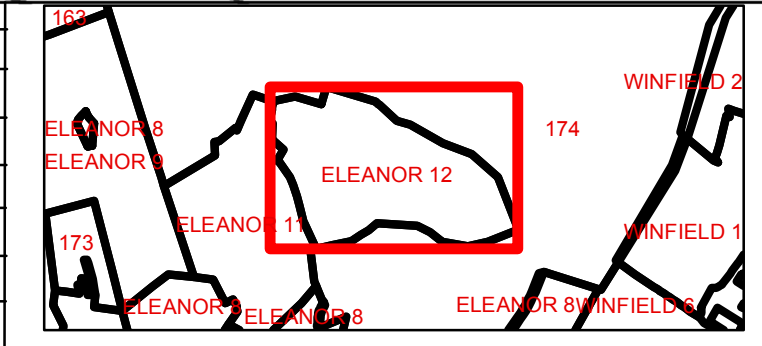

PUTNAM COUNTY
STATE OF WEST VIRGINIA
OFFICE OF ASSESSOR

Sheet No.: **ELEANOR 12**
District: ELEANOR TOWN
Date, Aerial Photography: 2010
Scale: 1" = 100'