



FOR TAX PURPOSES ONLY
PREPARED BY

SHERRY L. HAYES
PUTNAM COUNTY ASSESSOR

MAPPING / GIS DEPARTMENT

ALL TAX MAPS CREATED UNDER THE PROVISIONS OF REAPPRAISAL LEGISLATION ARE THE PROPERTY OF PUTNAM COUNTY WEST VIRGINIA AND THE REPRODUCTION, COPYING, DISTRIBUTION OR SALE OF SUCH TAX MAPS OR ANY COPIES THEREOF WITHOUT THE WRITTEN PERMISSION OF THE PUTNAM COUNTY ASSESSOR IS PROHIBITED BY LAW.

Legend		Revisions	
—	Road ROW	---	Lot Lines
---	Parcel Boundary	---	Utility Easement
---	Rail ROW	---	23 Parcel Number
---	Road-Rail ROW	---	001 Routing Number
---	District	---	(12) Deed Lot Number
---	Parcel Easement		
---	Parcel-Easement		
---	Parcel-Road ROW		
---	Parcel Hook		

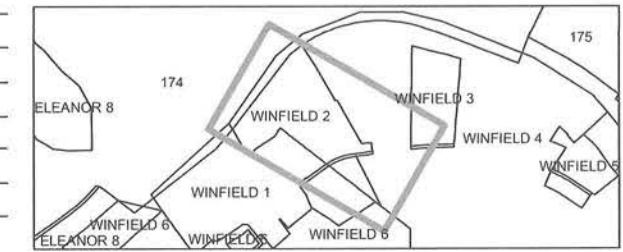

PUTNAM COUNTY
STATE OF WEST VIRGINIA
OFFICE OF ASSESSOR

District **WINFIELD TOWN**
Sheet No.: **WINFIELD 2**
Date, Aerial Photography: 2010
Scale: 1" = 100'