

FOR TAX PURPOSES ONLY

PREPARED BY
RALEIGH COUNTY ASSESSOR'S OFFICE
BECKLEY, WV

RESTRICTION

ALL TAX MAPS CREATED UNDER THE PROVISIONS OF REAPPRAISAL LEGISLATION ARE THE PROPERTY OF RALEIGH COUNTY, WEST VIRGINIA. THE REPRODUCTION, COPYING, DISTRIBUTION OR SALE OF SUCH TAX MAPS OR ANY COPIES THEREOF WITHOUT THE WRITTEN PERMISSION OF THE RALEIGH COUNTY ASSESSOR IS PROHIBITED BY LAW.

REVISIONS	
1	02/02/01 CLG
2	01/23/07 CLG
3	07/13/08 ADL
4	
5	
6	
7	
8	
9	
10	

LEGEND	
	TOWN DIST BECKLEY CORP CORPORATION/DISTRICT BOUNDARY AND NAME
	7TH STREET RIGHT-OF-WAY
	PROPERTY LINE
	ORIGINAL LOT LINE
	(9) DEED LOT NUMBER
	(38.0) PARCEL OR INDEX NUMBER
	(2) 2010 CHANGE
	(2) BLOCK NUMBER
	FAYETTE CO COUNTY BOUNDARY AND NAME
	RALEIGH CO COUNTY BOUNDARY AND NAME
	01-17 ORIGINAL MAP BOUNDARY AND NUMBER
	01-36 ORIGINAL MAP BOUNDARY AND NUMBER

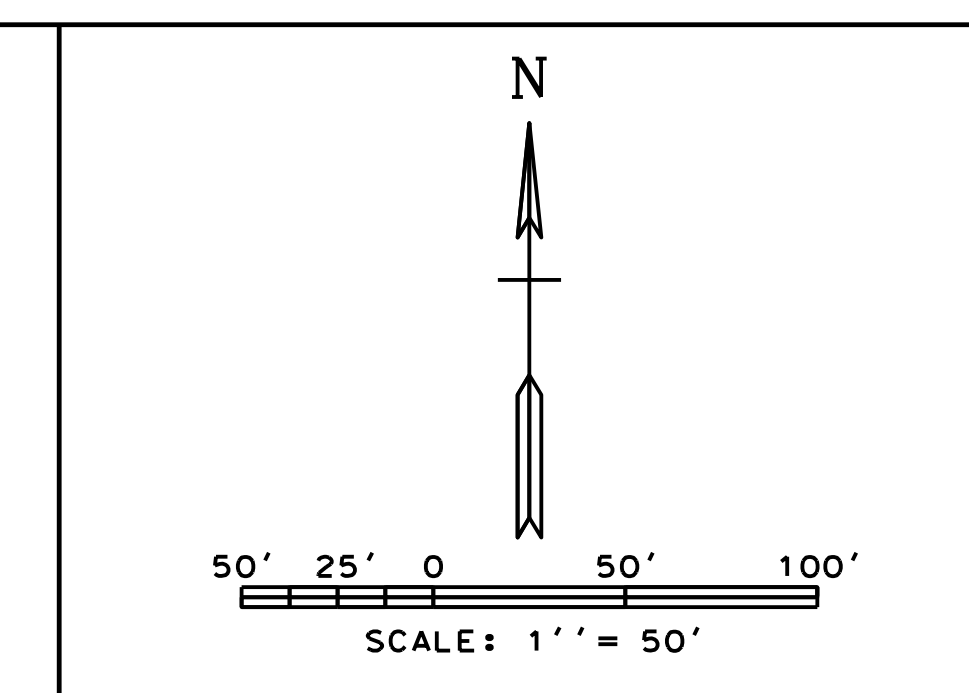

COUNTY OF RALEIGH
OFFICE OF ASSESSOR
BECKLEY, WEST VIRGINIA

BECKLEY CORPORATION
DISTRICT 01
MAP NO. 21