



FOR TAX PURPOSES ONLY
LANDMARK
 geospatial

Legend	
	District Boundary
	Previous Deed
	Property
	Road Easement
	Railroad Right of Way
	Road Right of Way
	River
	Deed lot Number (16)
	Parcel or Index Number UNKNOWN
	Improvement
	Cemetery
	School
	Church

Restriction

All tax maps created under the provisions of reappraisal legislation are the property of the Assessor of Randolph County, West Virginia and the reproduction, copying, modification, distribution or sale of such tax maps or any copies thereof without the written permission of the Randolph County Assessor is prohibited by law.

Revisions					
1	6-30-1964	10	OGIS J.E.B. 4-20-1995	19	S.T.P. 7-1-2015
2	T.R.L. 11-19-1980	11	SLS INC. J.W.M. 3-1997	20	S.T.P. 7-1-2016
3	D.F. 7-1-1983	12	P.K.Y. 7-1-2000	21	S.T.P. 5-18-2017
4	N.C.S. 7-1-1984	13	P.K.Y. 7-1-2002	22	
5	R.E.B. 7-1-1988	14	P.K.Y. 7-1-2004	23	
6	D.F. 7-1-1989	15	A.K.B. 7-1-2005	24	
7	OGIS 3-4-1991	16	A.K.B. 7-1-2009	25	
8	OGIS T.L. 4-30-1992	17	S.T.P. 7-1-2013	26	
9	OGIS J.E.B. 3-15-1994	18	S.T.P. 7-1-2014	27	
				28	
				29	
				30	
				31	
				32	
				33	
				34	
				35	
				36	

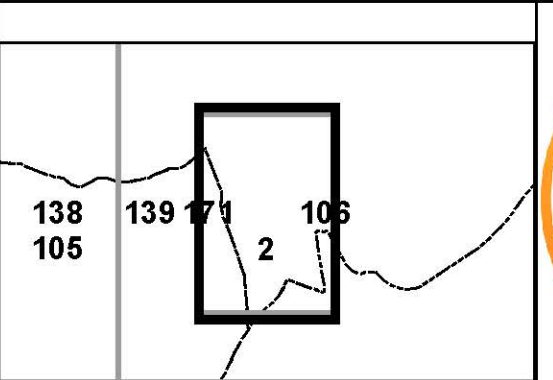

RANDOLPH COUNTY
 Assessor's Office
 Phyllis K. Yokum, Assessor
 ELKINS, WV

BEVERLY
 District 02 Map No. 2
 Date of Publication: 1/28/2019
 Scale: 1"=100'