



**FOR TAX PURPOSES ONLY**  
**LANDMARK**  
 geospatial

Legend	
	District Boundary
	Previous Deed
	Property
	Road Easement
	Railroad Right of Way
	Road Right of Way
	River
	Deed lot Number (16)
	Parcel or Index Number
	UNKNOWN
	Improvement
	Cemetery
	School
	Church

**Restriction**

All tax maps created under the provisions of reappraisal legislation are the property of the Assessor of Randolph County, West Virginia and the reproduction, copying, modification, distribution or sale of such tax maps or any copies thereof without the written permission of the Randolph County Assessor is prohibited by law.

Revisions					
1	D.F. 7-1980	10	SLS INC. J.W.M. 3-1997	19	28
2	T.R.L. 7-1983	11	P.K.Y. 7-1-1998	20	29
3	C.P. 7-1-1984	12	P.K.Y. 7-1-2002	21	30
4	D.F. 7-1-1987	13	A.K.B. 7-1-2007	22	31
5	OGIS 3-4-1991	14	A.L.I. 7-1-2010	23	32
6	OGIS T.L. 4-30-1992	15	S.T.P. 5-18-17	24	33
7	OGIS T.R.L. 5-6-1993	16		25	34
8	OGIS J.E.B. 4-20-1995	17		26	35
9	OGIS J.E.B. 5-1-1996	18		27	36

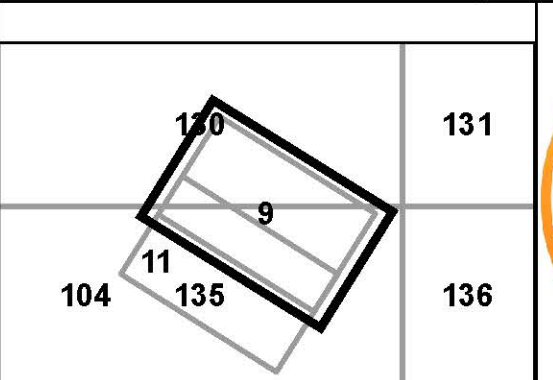

**RANDOLPH COUNTY BEVERLY**  
 Assessor's Office  
 Phyllis K. Yokum, Assessor  
 ELKINS, WV

District 02      Map No. 9  
 Date of Publication: 1/28/2019  
 Scale: 1"=100'