



FOR TAX PURPOSES ONLY
LANDMARK
 geospatial

Legend	
	District Boundary
	Previous Deed
	Property
	Road Easement
	Railroad Right of Way
	Road Right of Way
	River
	Deed lot Number
	Parcel or Index Number
	UNKNOWN
	Improvement
	Cemetery
	School
	Church

Restriction

All tax maps created under the provisions of reappraisal legislation are the property of the Assessor of Randolph County, West Virginia and the reproduction, copying, modification, distribution or sale of such tax maps or any copies thereof without the written permission of the Randolph County Assessor is prohibited by law.

Revisions					
1	6-30-1964	10	19	28	
2	T.R.L. 11-26-1980	11	20	29	
3	N.C.S. 7-1-1984	12	21	30	
4	D.F. 7-1-1988	13	22	31	
5	OGIS T.L. 4-30-1992	14	23	32	
6	OGIS J.E.B. 5-1-1996	15	24	33	
7	P.K.Y. 7-1-2001	16	25	34	
8	A.K.B. 7-1-2006	17	26	35	
9	S.T.P. 5-18-2017	18	27	36	

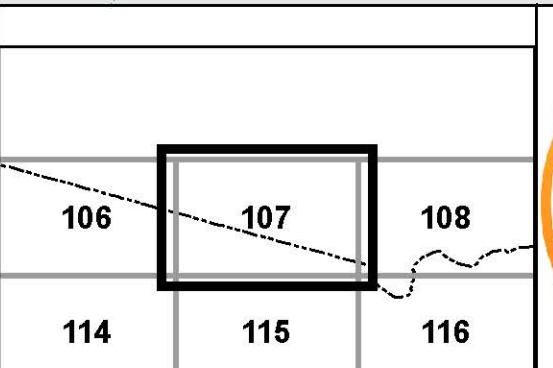

RANDOLPH COUNTY
 Assessor's Office
 Phyllis K. Yokum, Assessor
 ELKINS, WV

DRY FORK
 District 04 Map No. 107
 Date of Publication: 1/28/2019
 Scale: 1"=400'