

**FOR TAX PURPOSES ONLY**  
**LANDMARK**  
 geospatial

| Legend |                                |
|--------|--------------------------------|
|        | District Boundary              |
|        | Previous Deed                  |
|        | Property                       |
|        | Road Easement                  |
|        | Railroad Right of Way          |
|        | Road Right of Way              |
|        | River                          |
|        | Deed lot Number (16)           |
|        | Parcel or Index Number UNKNOWN |
|        | Improvement                    |
|        | Cemetery                       |
|        | School                         |
|        | Church                         |

**Restriction**

All tax maps created under the provisions of reappraisal legislation are the property of the Assessor of Randolph County, West Virginia and the reproduction, copying, modification, distribution or sale of such tax maps or any copies thereof without the written permission of the Randolph County Assessor is prohibited by law.

| Revisions |         |          |    |    |    |
|-----------|---------|----------|----|----|----|
| 1         | NEW MAP | 7-1-2009 | 10 | 19 | 28 |
| 2         |         |          | 11 | 20 | 29 |
| 3         |         |          | 12 | 21 | 30 |
| 4         |         |          | 13 | 22 | 31 |
| 5         |         |          | 14 | 23 | 32 |
| 6         |         |          | 15 | 24 | 33 |
| 7         |         |          | 16 | 25 | 34 |
| 8         |         |          | 17 | 26 | 35 |
| 9         |         |          | 18 | 27 | 36 |

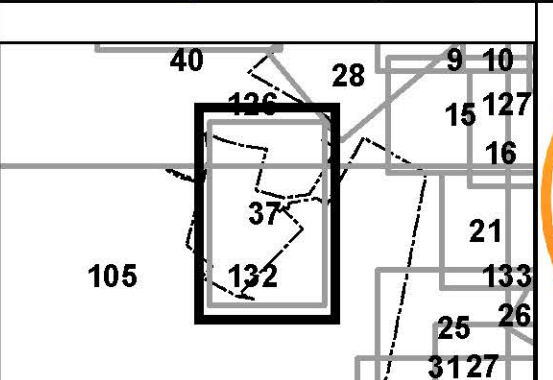

**RANDOLPH COUNTY**  
 Assessor's Office  
 Phyllis K. Yokum, Assessor  
 ELKINS, WV

**ELKINS CORP**  
 District 05 Map No. 37  
 Date of Publication: 1/28/2019  
 Scale: 1"=100'