



P/O 147-1

P/O 139-1

P/O 147-1

P/O 153-5

(LOT B)

(101C)

10
100 Ac.

9
50.06 Ac.

7
50.06 Ac.

8
88.14 Ac.

2
240 Ac.

21
72 Ac.

9
36 Ac.

5
90 Ac.

3
36 Ac.

4
72 Ac.



FOR TAX PURPOSES ONLY
LANDMARK
geospatial

Legend	
	District Boundary
	Previous Deed
	Property
	Road Easement
	Railroad Right of Way
	Road Right of Way
	River
	Deed lot Number (16)
	Parcel or Index Number
	UNKNOWN
	Improvement
	Cemetery
	School
	Church

Restriction

All tax maps created under the provisions of reappraisal legislation are the property of the Assessor of Randolph County, West Virginia and the reproduction copying, modification, distribution or sale of such tax maps or any copies thereof without the written permission of the Randolph County Assessor is prohibited by law.

Revisions					
1	6-30-1964	10	SLS INC. J.W.M.	4-1997	19
2	T.R.L. 7-1984	11	P.K.Y.	7-1-2004	20
3	C.P. 7-1-1986	12	A.K.B.	7-1-2009	21
4	N.C.S. 7-1-1988	13			22
5	D.F. 7-1-1989	14			23
6	OGIS 3-3-1991	15			24
7	OGIS J.E.B. 4-15-1992	16			25
8	OGIS J.E.B. 3-15-1994	17			26
9	OGIS J.E.B. 4-20-1995	18			27
					28
					29
					30
					31
					32
					33
					34
					35
					36

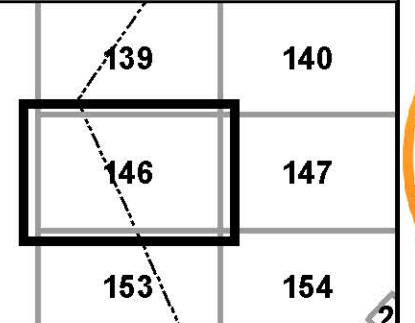

RANDOLPH COUNTY
Assessor's Office
Phyllis K. Yokum, Assessor
ELKINS, WV

MIDDLE FORK
District 11 Map No. 146
Date of Publication: 1/28/2019
Scale: 1"=400'