

FOR TAX PURPOSES ONLY
LANDMARK
 geospatial

Legend	
-----	District Boundary
-----	Previous Deed
-----	Road Easement
-----	Road Right of Way
-----	River
①	Parcel or Index Number
UNKNOW	Improvement
○	Cemetery
□	School
⚡	Church

Restriction

All tax maps created under the provisions of reappraisal legislation are the property of the Assessor of Randolph County, West Virginia and the reproduction copying, modification, distribution or sale of such tax maps or any copies thereof without the written permission of the Randolph County Assessor is prohibited by law.

Revisions					
1	6-30-1964	10	19	28	
2	D.F. 7-1-1989	11	20	29	
3		12	21	30	
4		13	22	31	
5		14	23	32	
6		15	24	33	
7		16	25	34	
8		17	26	35	
9		18	27	36	

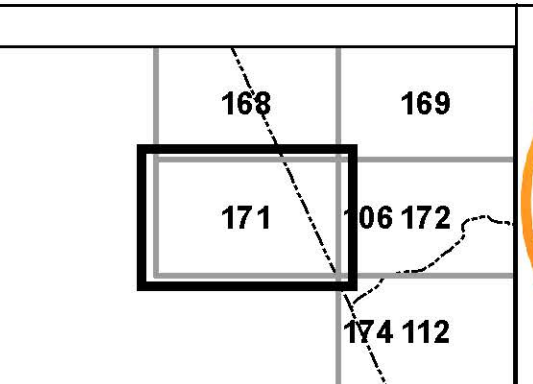

RANDOLPH COUNTY
 Assessor's Office
 Phyllis K. Yokum, Assessor
 ELKINS, WV

MIDDLE FORK
 District 11 Map No. 171
 Date of Publication: 1/28/2019
 Scale: 1"=400'