

05

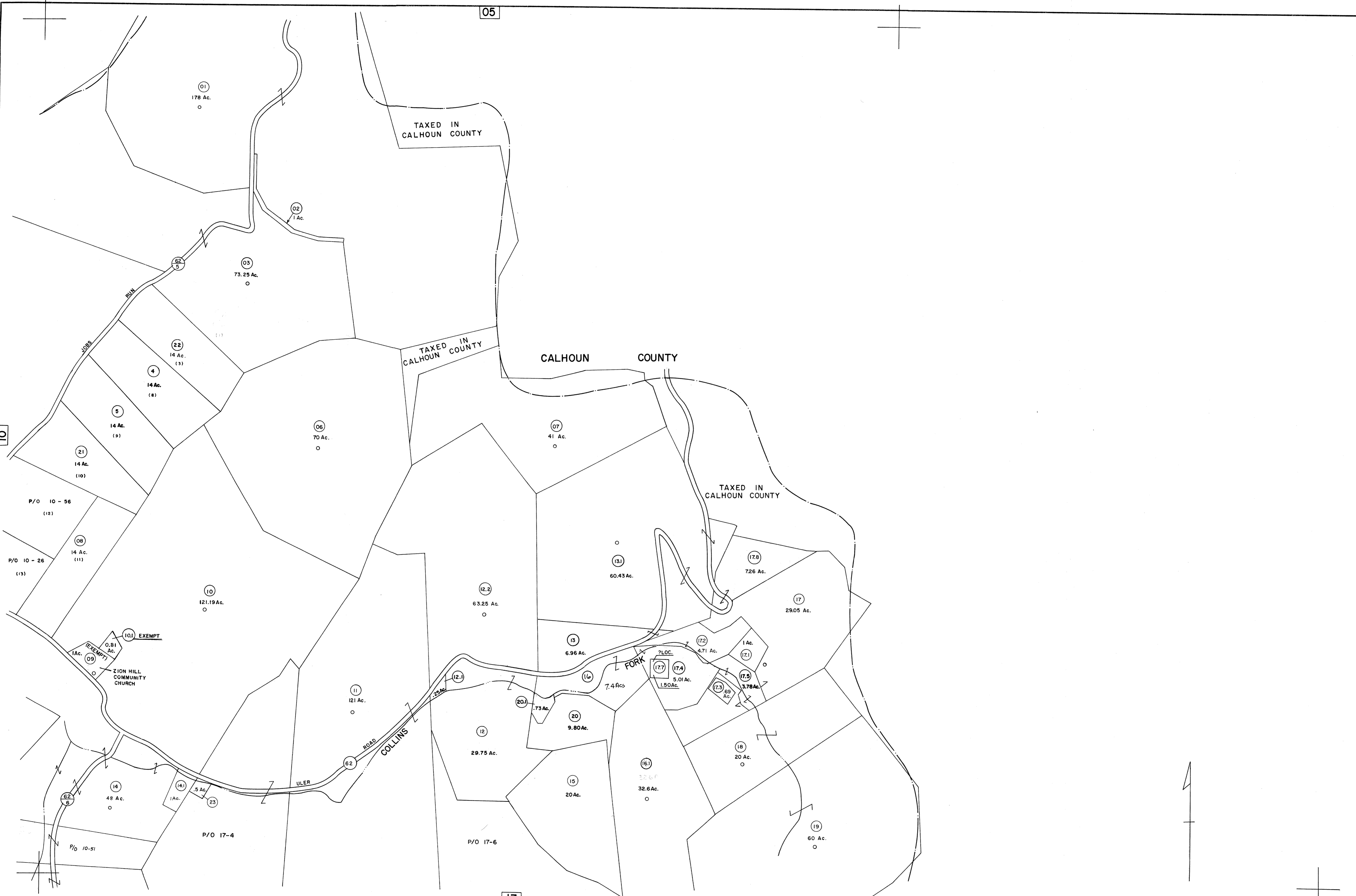

17

FOR TAX PURPOSES ONLY

Prepared by  
**L. ROBERT KIMBALL**  
 Consulting Engineer  
 Ebensburg, Pennsylvania

LEGEND

Property line	Original lot line
Edge of pavement or roadway	Deed lot number in parenthesis
Corporation line	Parcel or index number in circle
District line	Improvement
County line	Railroad

REVISIONS

1	4-8-80	NCS	9	7/2/04	S&H	17
2	REV. TO 7-1-82	NCS	10	6/22/05	S&H	18
3	REV. TO 7-83	MEN	11	10/7/08	S&H	19
4	To 7/1/87		12	4/22/11	S&H	20
5	EXCALIBUR	2/99	13	2/22/16	S&H	21
6	1/18/2000	S&H	14	1/11/18	HDM	22
7	3/11/2001	S&H	15			23
8	3/8/2002	S&H	16			24

STATE OF WEST VIRGINIA  
 COUNTY OF ROANE  
 Office of Assessor

GEARY DISTRICT  
 SHEET II

Date, Aerial Photography: APRIL, 1960 Date, Map: JAN, 1961  
 Photo No: 12-75 Scale: 1"=400'