

FOR TAX PURPOSES ONLY

Prepared By:  
**Greg Vandall**  
 Summers County Assessor

**Legend**

Property Line	—	Original Lot Line	—
Road Right of Way	—	Lot Number	(15)
Corporation Line	—	Parcel Number	(99)
District Line	—	Water	—
County Line	—	Railroad	—

R	1	Revised 6/1/16	9	17
O	2	Revised 12/30/2016	10	18
V	3	Revised 02/26/2018	11	19
J	4	Revised 01/30/2019	12	20
S	5		13	21
I	6		14	22
O	7		15	23
N	8		16	24

**STATE OF WEST VIRGINIA**  
**COUNTY OF SUMMERS**  
 Office of Assessor

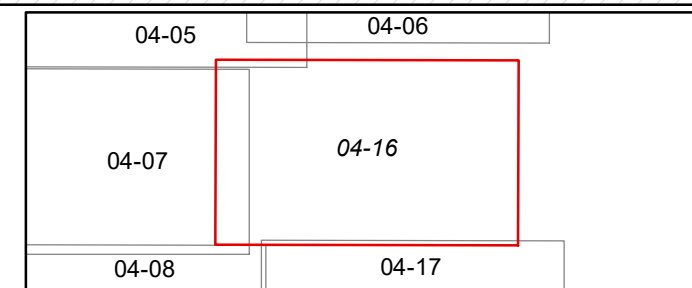

**HINTON CORP**  
 Map: 16  
 Date, Aerial Photography: 2003  
 Date, Map: 1/30/2019  
 Scale: 1" = 100'